

M109G German Self-Propelled Howitzer **155MM/L23 HOWITZER** ドイツ陸軍 M109G 155mm / L23自走榴弾砲



**AFV
CLUB**
1/35 SCALE

NOTE MODELLISTICHE PER LA REALIZZAZIONE DI UN ESEMPLARE DELL'ESERCITO ITALIANO

di Pierantonio Farina
per www.ferreamole.it

Di seguito vengono riportate le istruzioni del modello della AFV Club modificate per consentire la riproduzione di un semovente M109G in servizio in Italia.

La modifiche apportate consistono in:

- 1- sostituzione dei numeri di riferimento di alcune parti per indicare quelli corretti per le parti caratteristiche dei semoventi italiani. Dato che i disegni non sono stati modificati si faccia sempre riferimento alla numerazione per l'identificazione delle parti,
- 2 - oscuramento dei passi non applicabili alla realizzazione del modello,
- 3 - identificazione con una **X** delle parti da non installare sul modello o delle operazioni da non eseguire.

AVVERTENZA:

I cingoli T-136 utilizzati su questa versione devono essere acquistati a parte.

A titolo d'esempio sono disponibili i seguenti kit:

- Italeri con codice 6515
- Friulmodel con codice ATL-139
- Riich Model con codice RE30002
- AFV Club con codice 35S23

I cingoli forniti nel kit possono essere usati per la versione M109L

Prima di incollare le parti che compongono le ruote motrici verificare che i cingoli si innestino correttamente su di esse. Potrebbe essere necessario applicare dei distanziatori tra le parti e/o accorciare i denti guidacingolo.

NOTE PER LA REALIZZAZIONE DEI CESTI POSTERIORI:

Separare dagli sprue le parti che compongono i cesti posteriori con attenzione perché assai fragili. Utilizzare una lama affilata. Per separare le parti P8 utilizzare una microsega e poi rifinirle con una lama. La posizione dei ponti con gli sprue causerà la loro rottura se si utilizza solo una lama.

Preparazione della parti prima dell'incollaggio:

- eliminare dalle parti P5 la guida superiore che delimita il punto di incollaggio della parti orizzontali (deve rimanere solo la guida inferiore)
- eliminare delle parti P4 e P7 il cilindretto da inserire nelle casse posteriori perché non combaciano correttamente con esse

Sequenza consigliata di montaggio:

- incollare le parti P3 e P7,
- incollare due parti P5 partendo dall'interno,
- incollare la terza parte P5 (quella obliqua)
- incollare la parte P6
- Incollare la parte P4



Tutte le foto dei semoventi provengono dall'archivio di ferreamole.it

Revisione dicembre 2021 - www.ferreamole.it

1

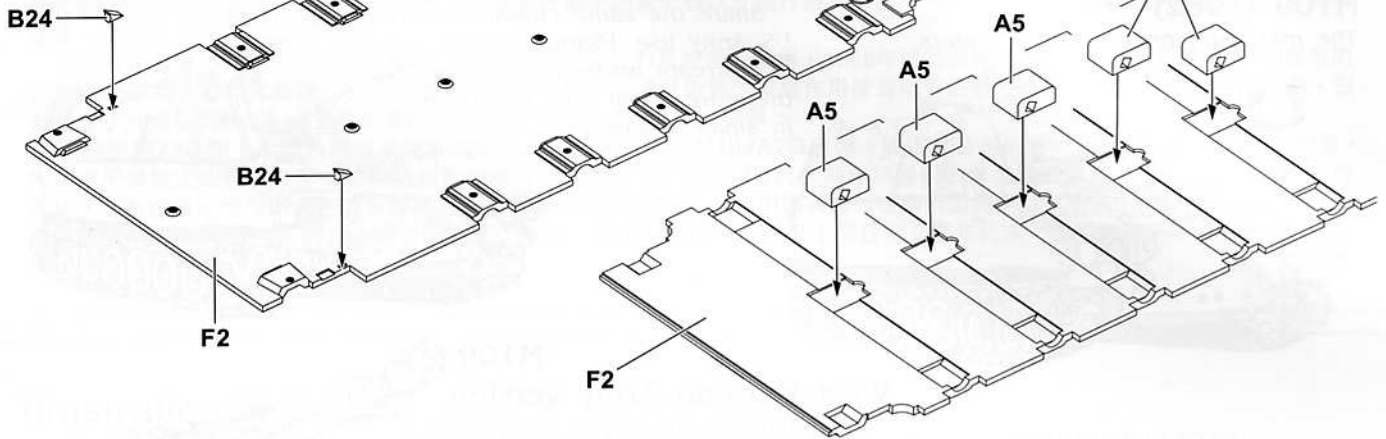
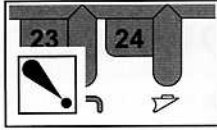

2

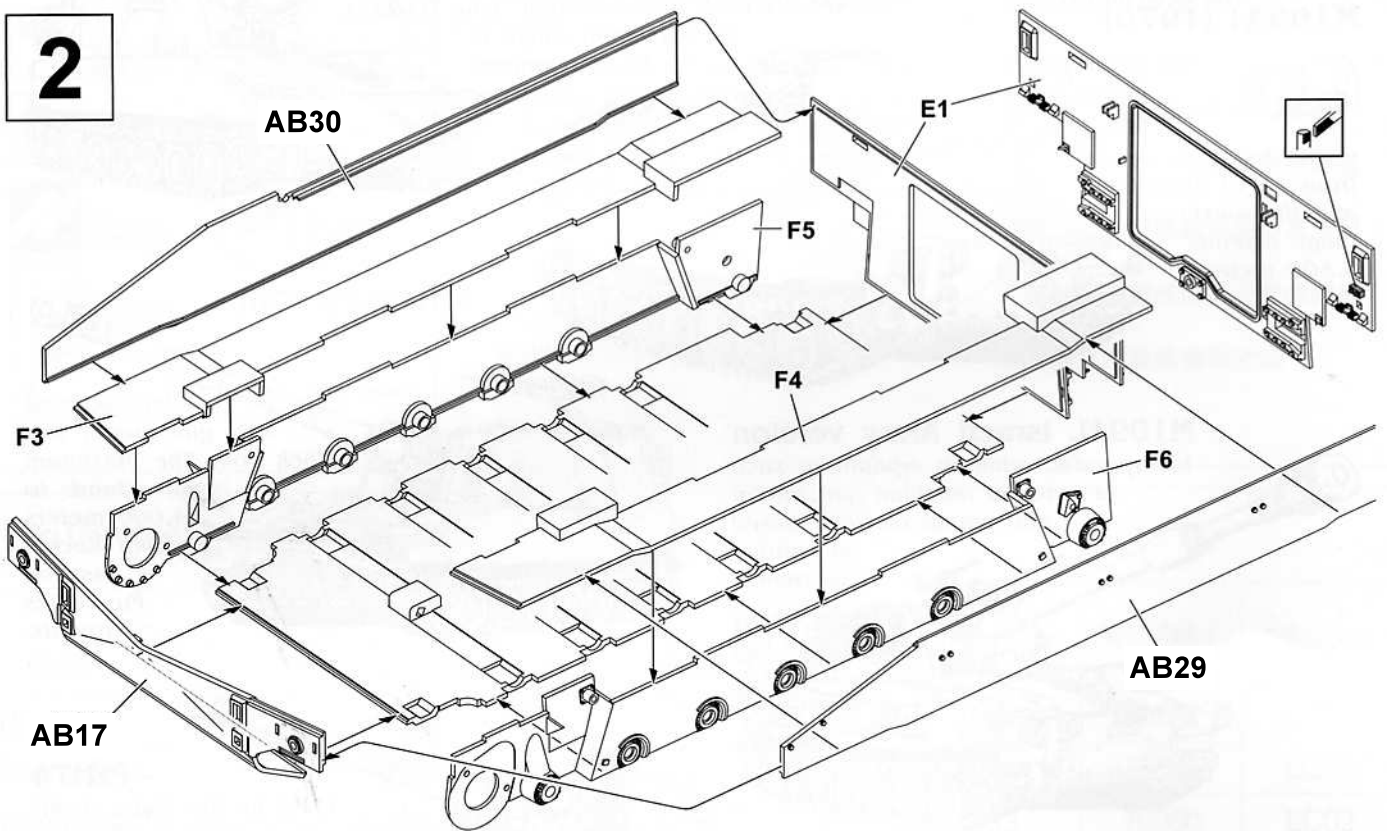

3

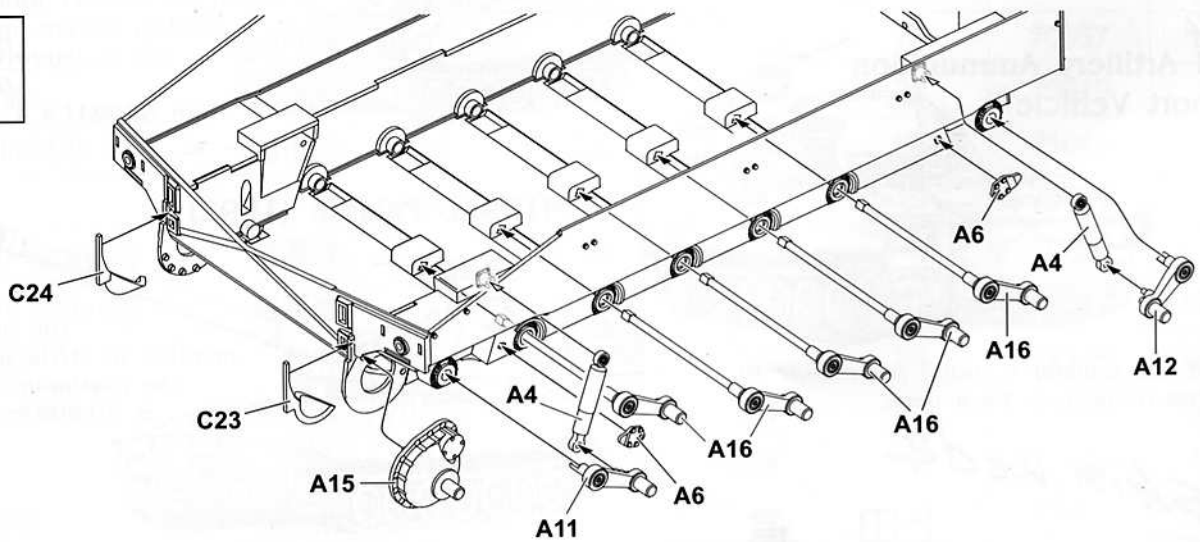

4

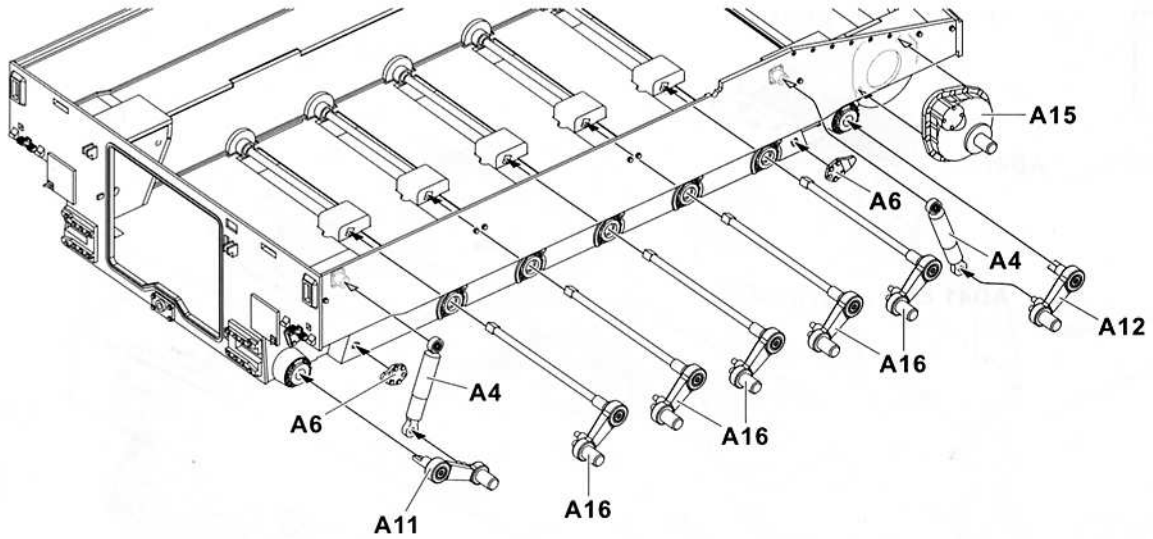

5

Prima di incollare le parti della ruota motrice verificare che il cingolo si innesti correttamente.

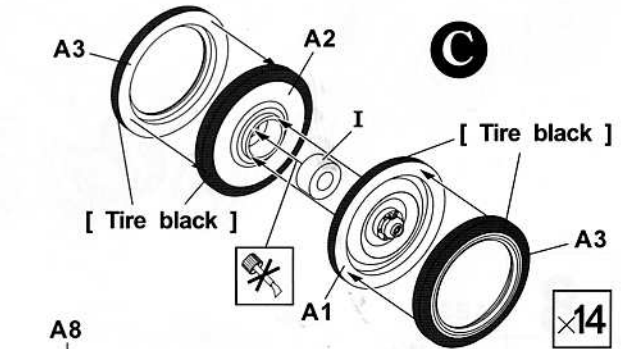
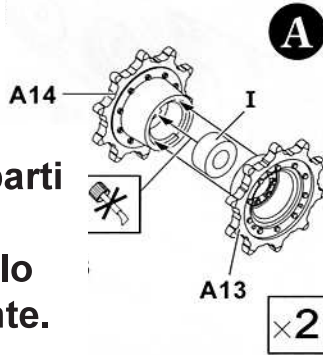

German Army M109G
(Late version)
德國陸軍(後期型)

Norwegian Army M109GN
挪威陸軍

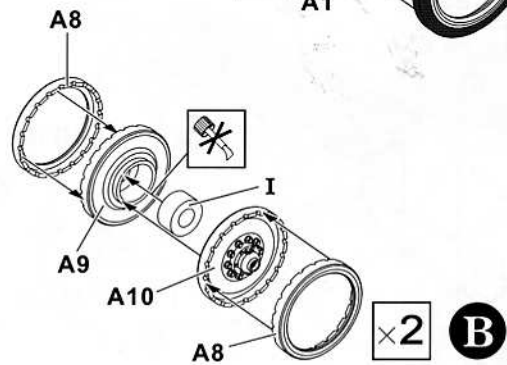
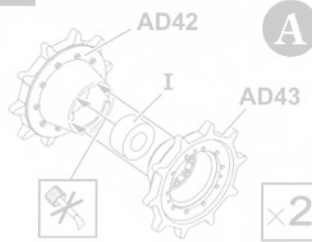

6

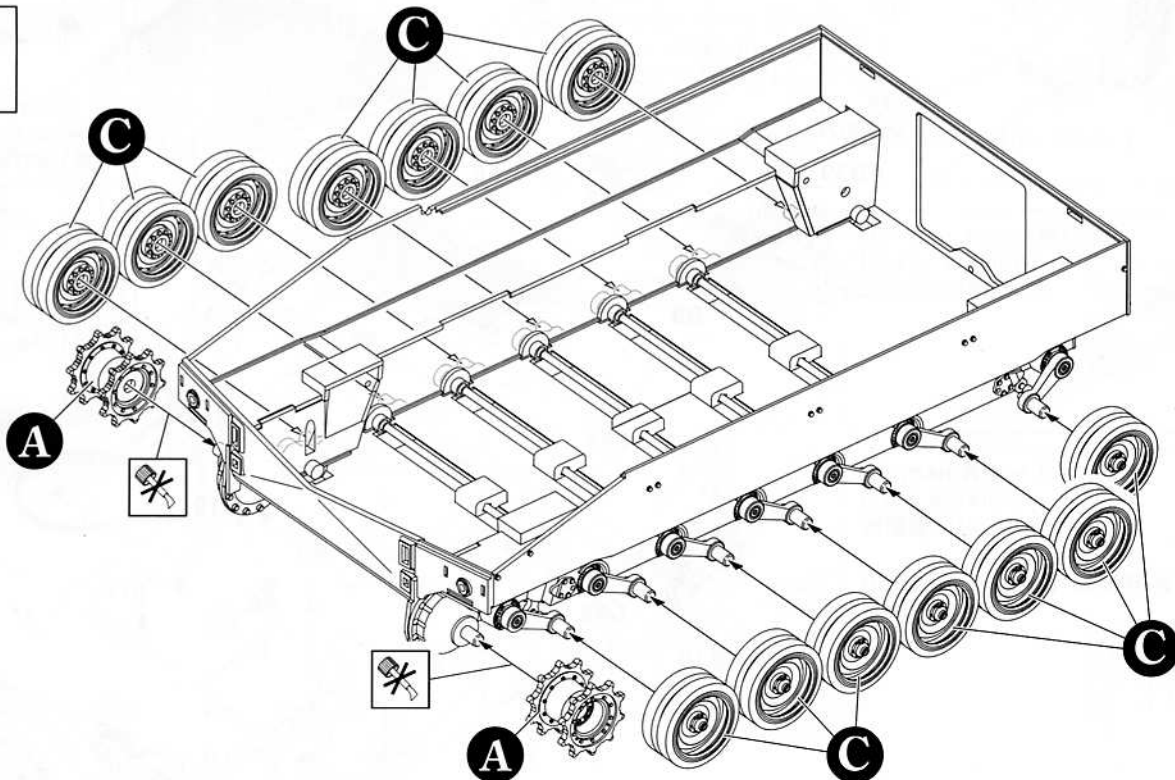

7

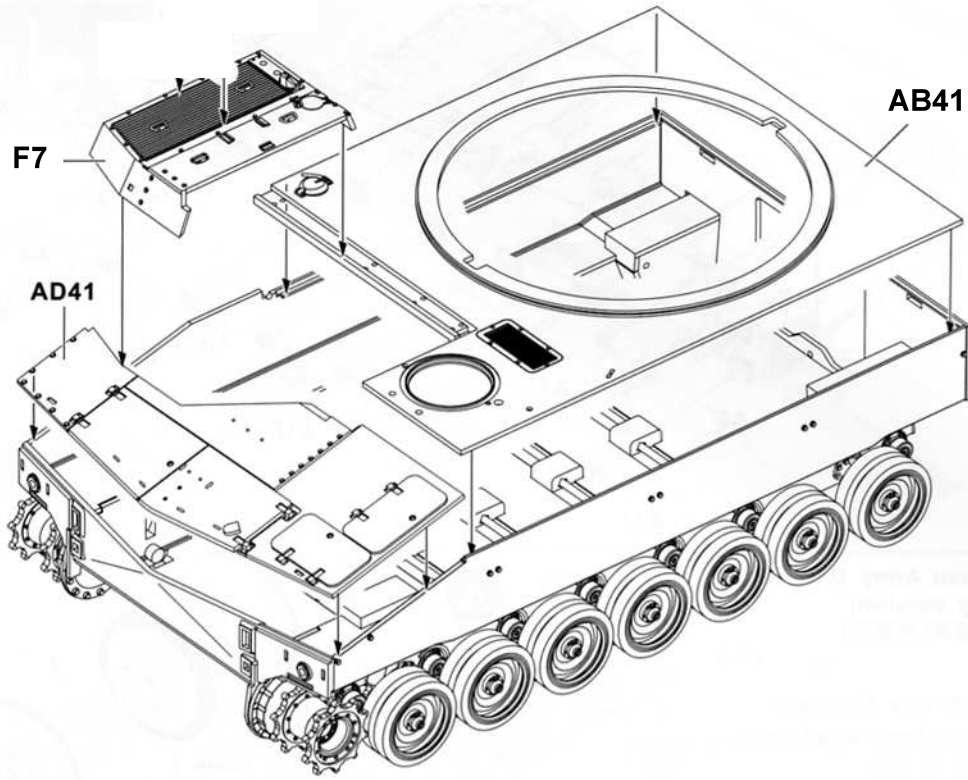

8

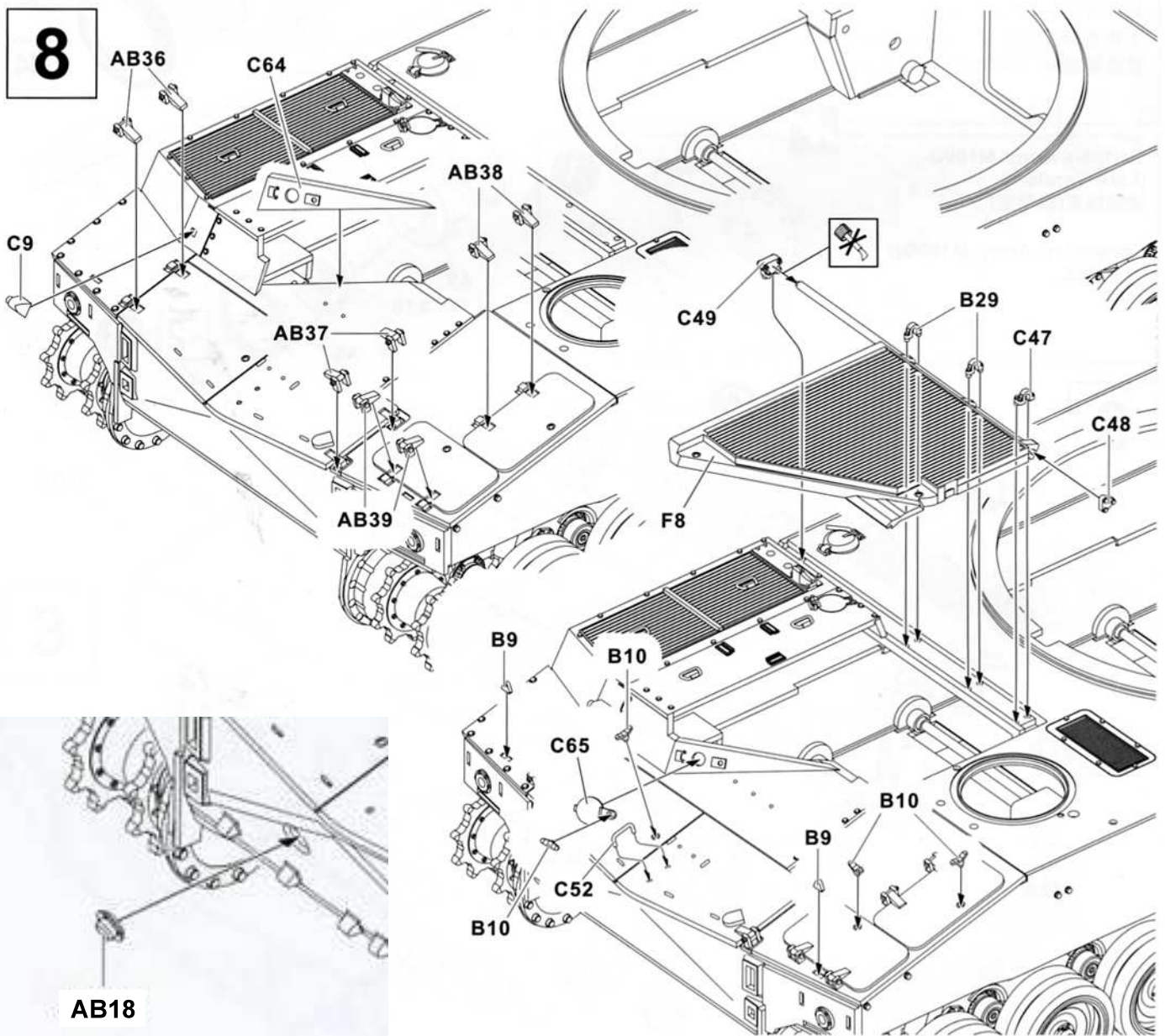

9

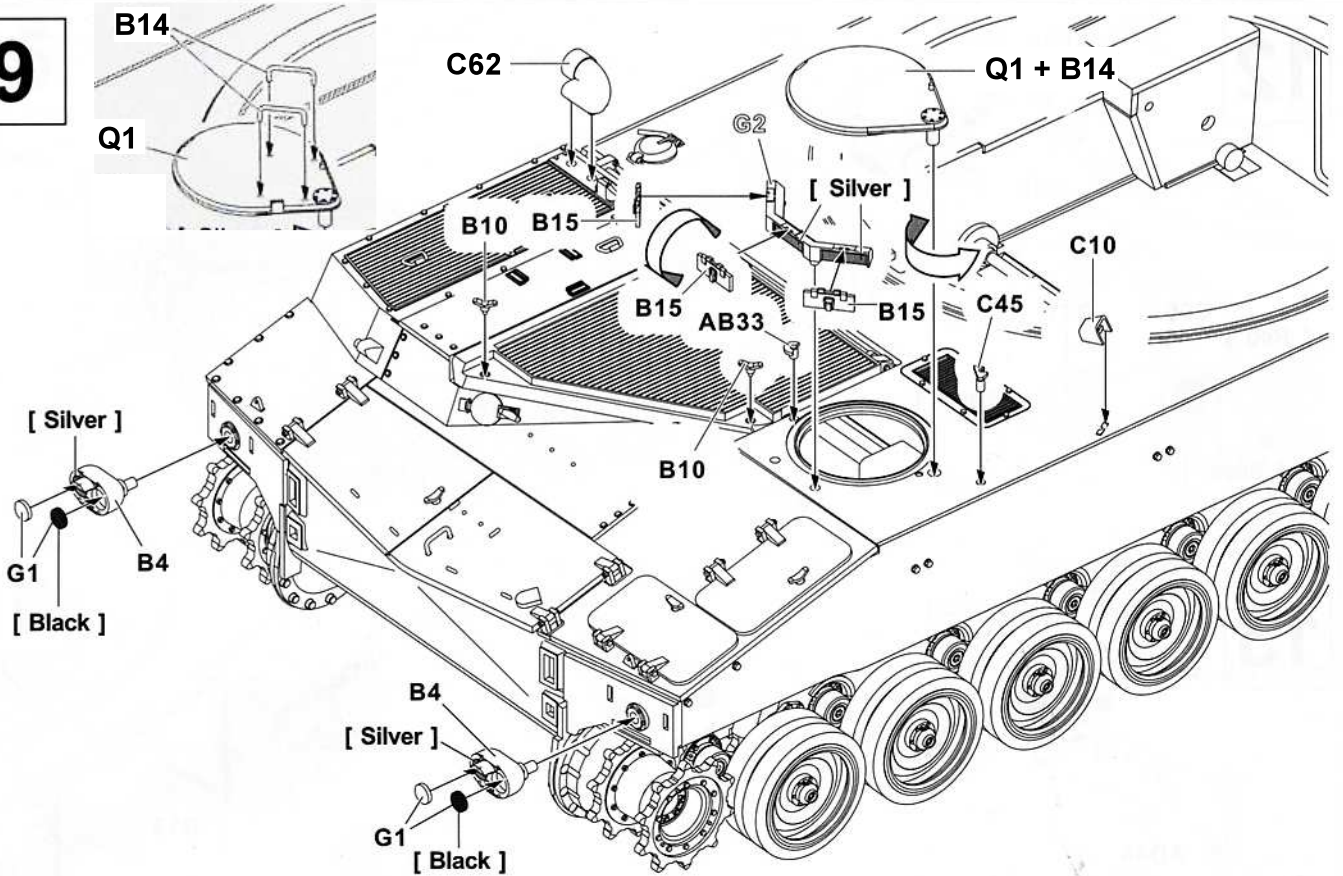

10

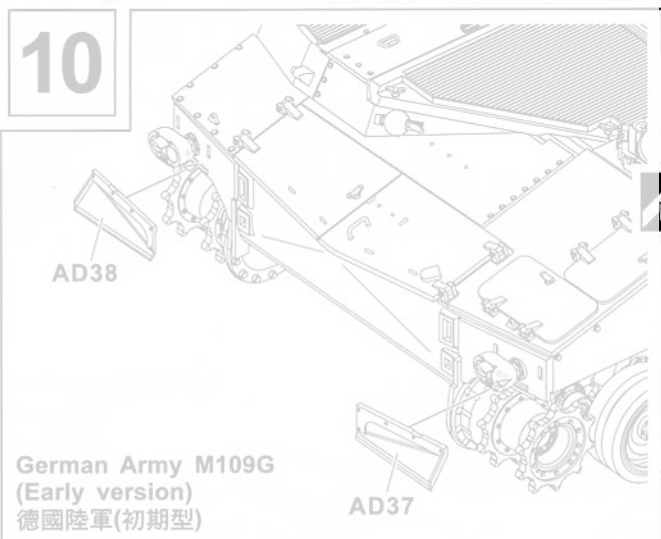

German Army M109G
(Early version)
德國陸軍(初期型)

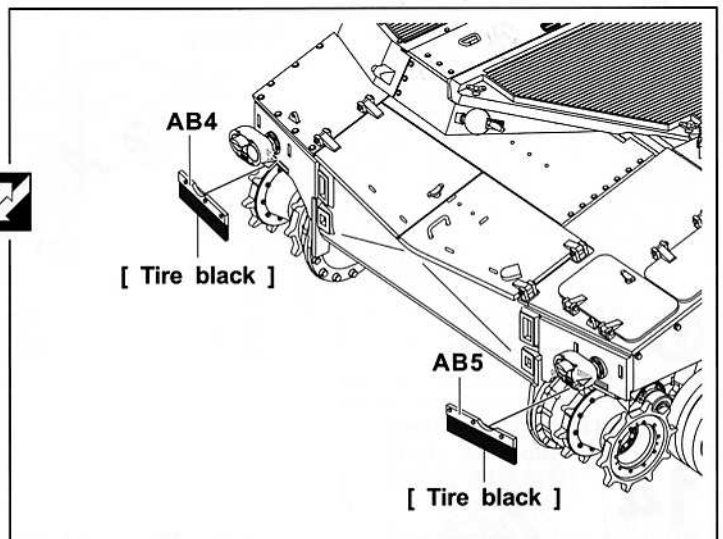

11

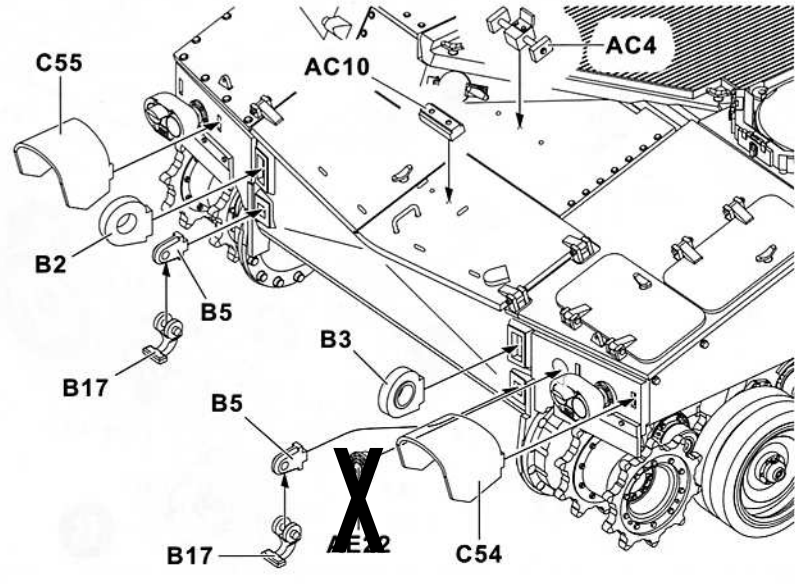

German Army M109G
(Early version)
德國陸軍(初期型)

AE22

German Army M109G
(Late version)
德國陸軍(後期型)

Norwegian Army M109GN
挪威陸軍

AE22

12

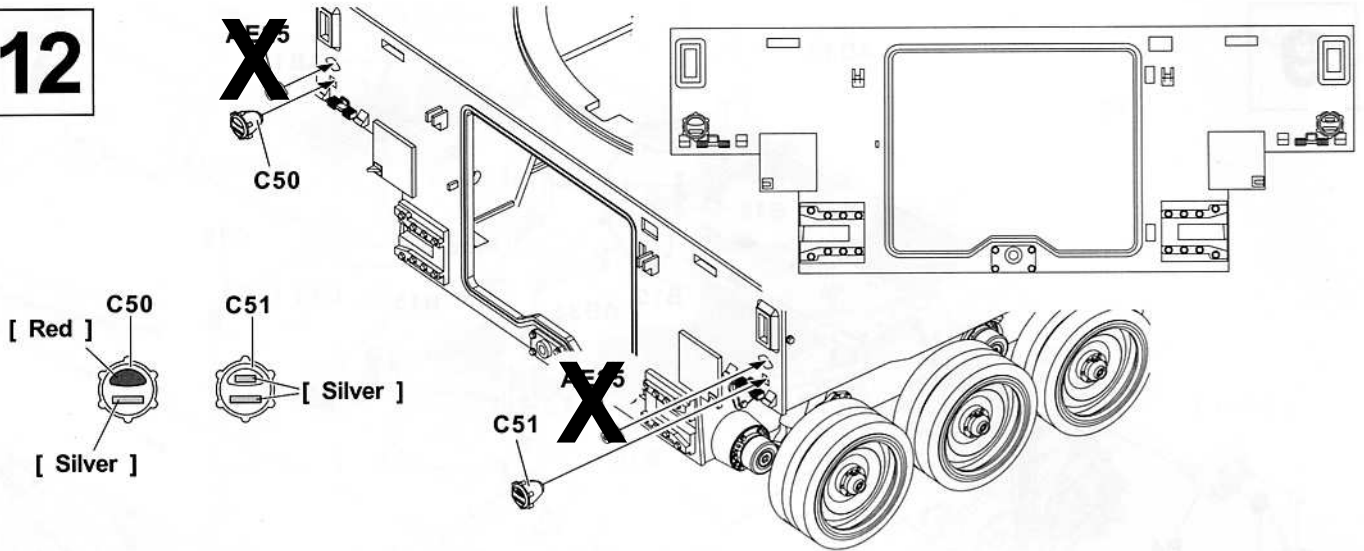

13

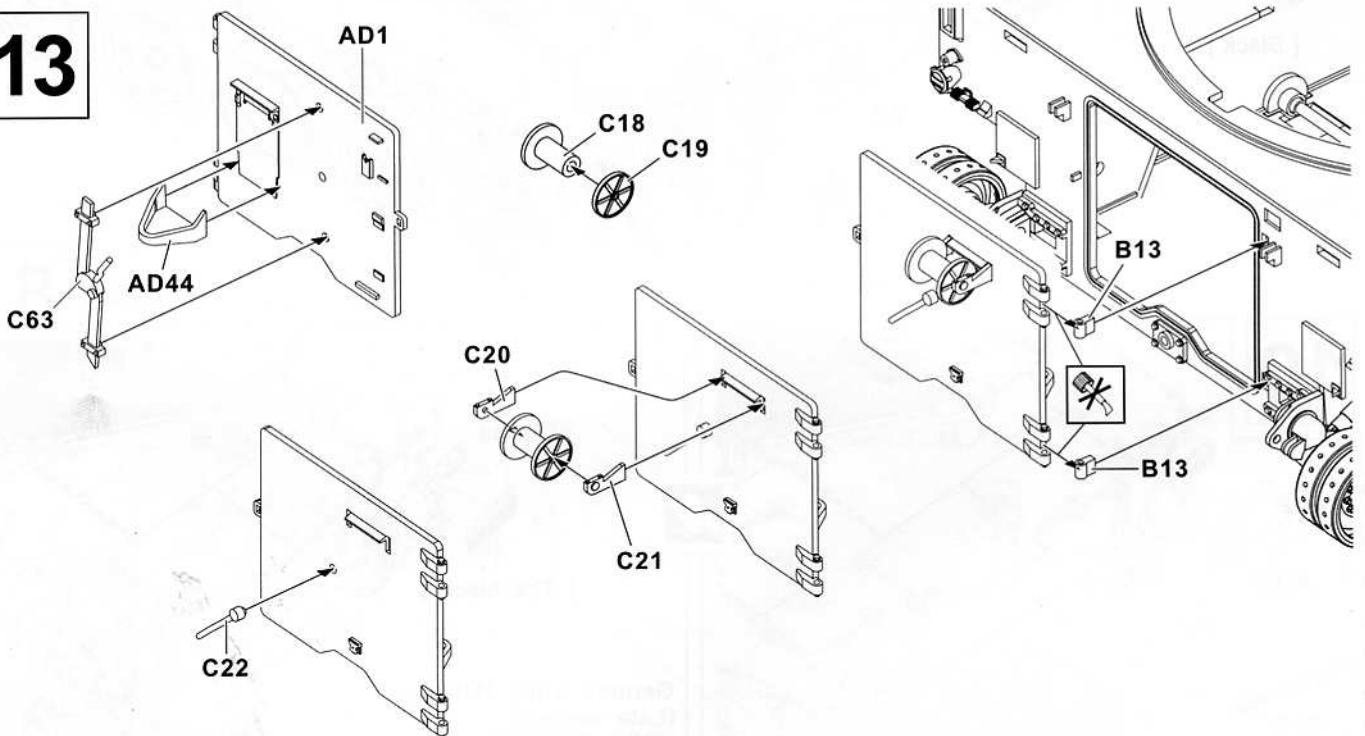

14

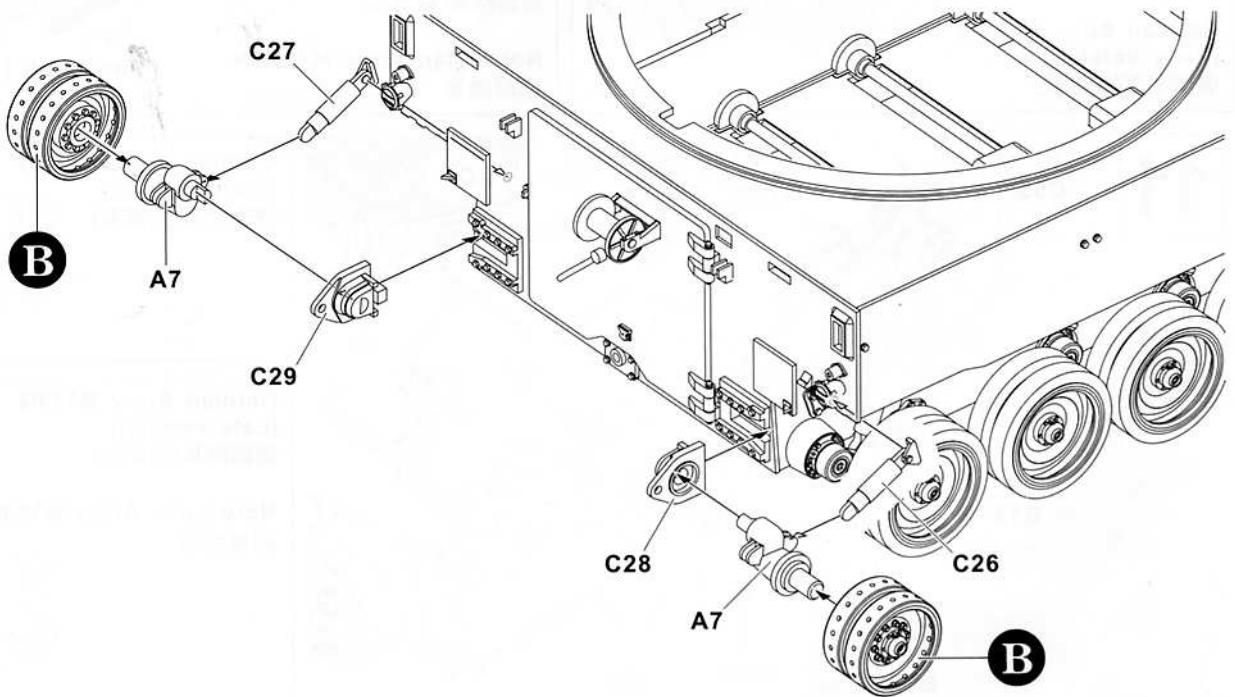

15

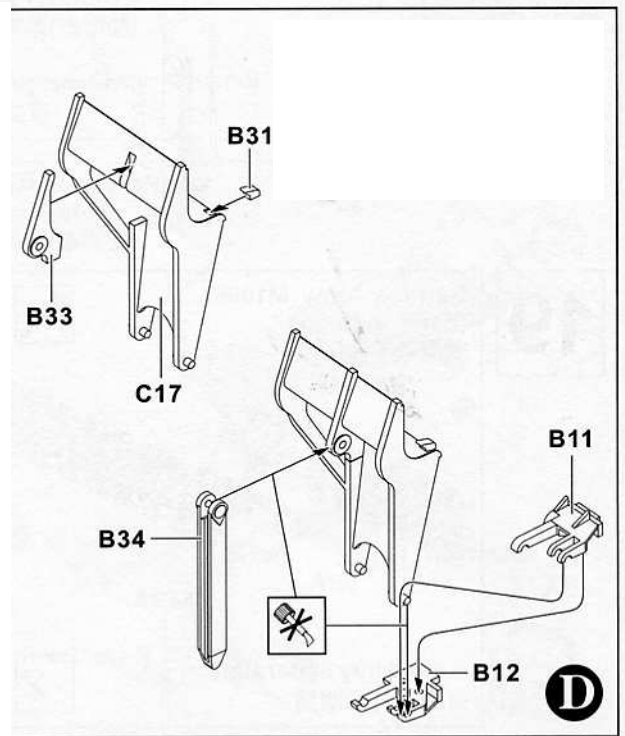
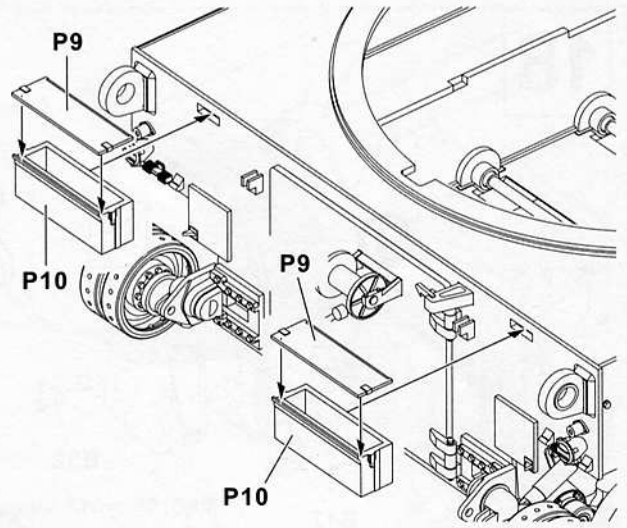
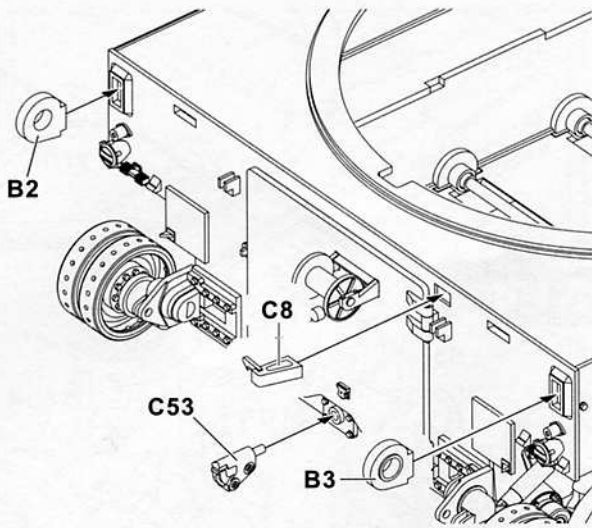

17

German Army M109G (Early version) 德國陸軍(初期型)

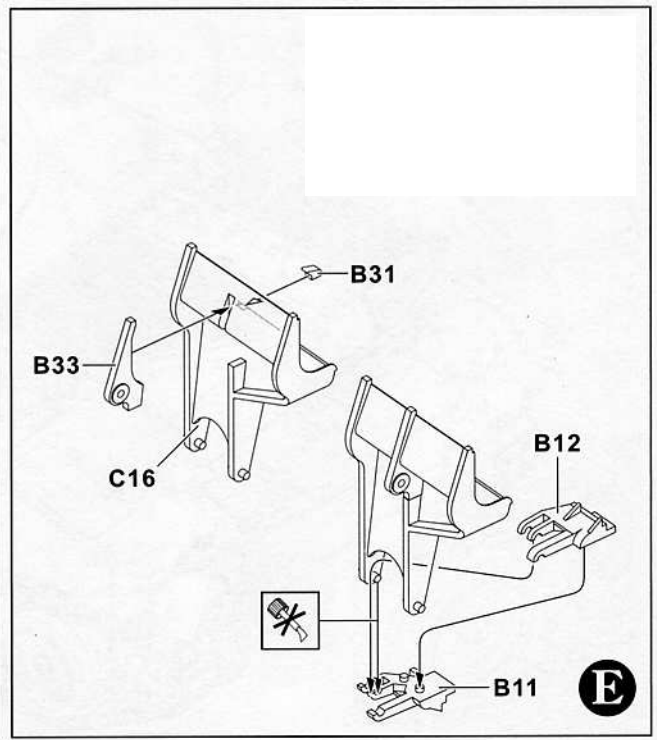
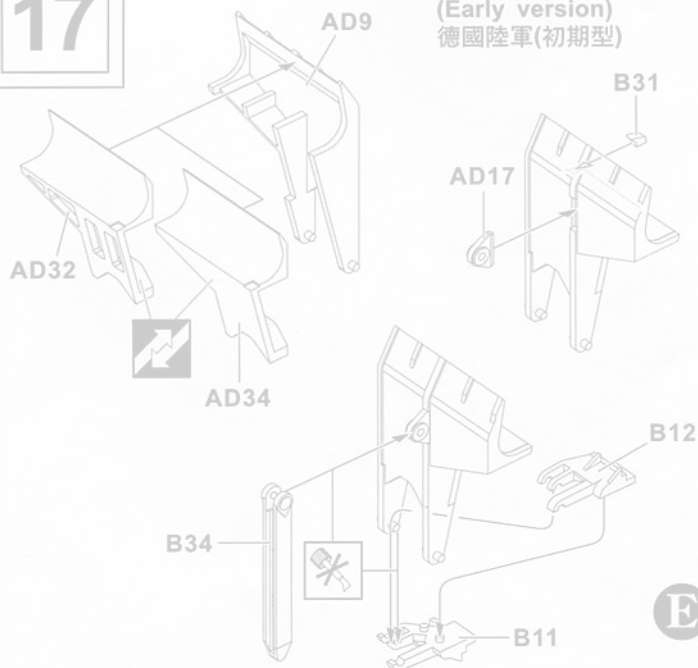

18

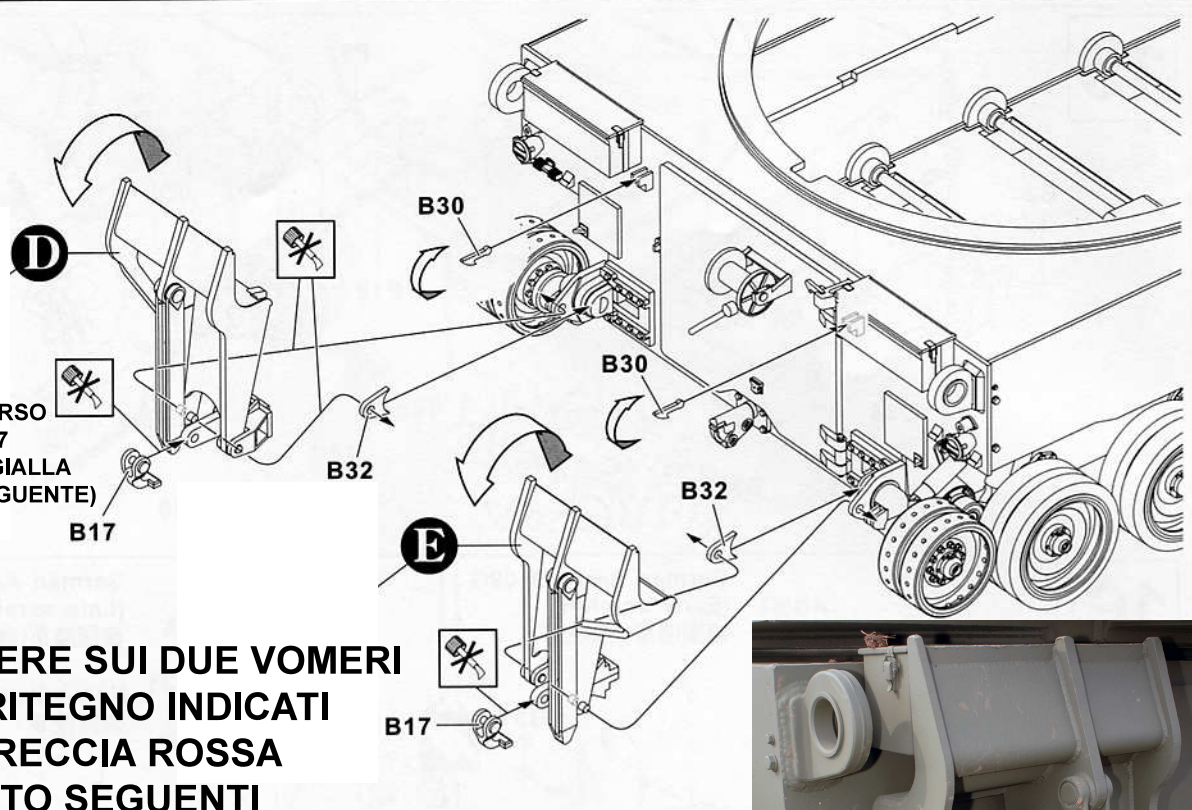

INVERTIRE IL VERSO DELLE PARTI B17 (VEDI FRECCIA GIALLA NELLA FOTO SEGUENTE)

AGGIUNGERE SUI DUE VOMERI I CAVI DI RITEGNO INDICATI CON LA FRECCIA ROSSA NELLE FOTO SEGUENTI

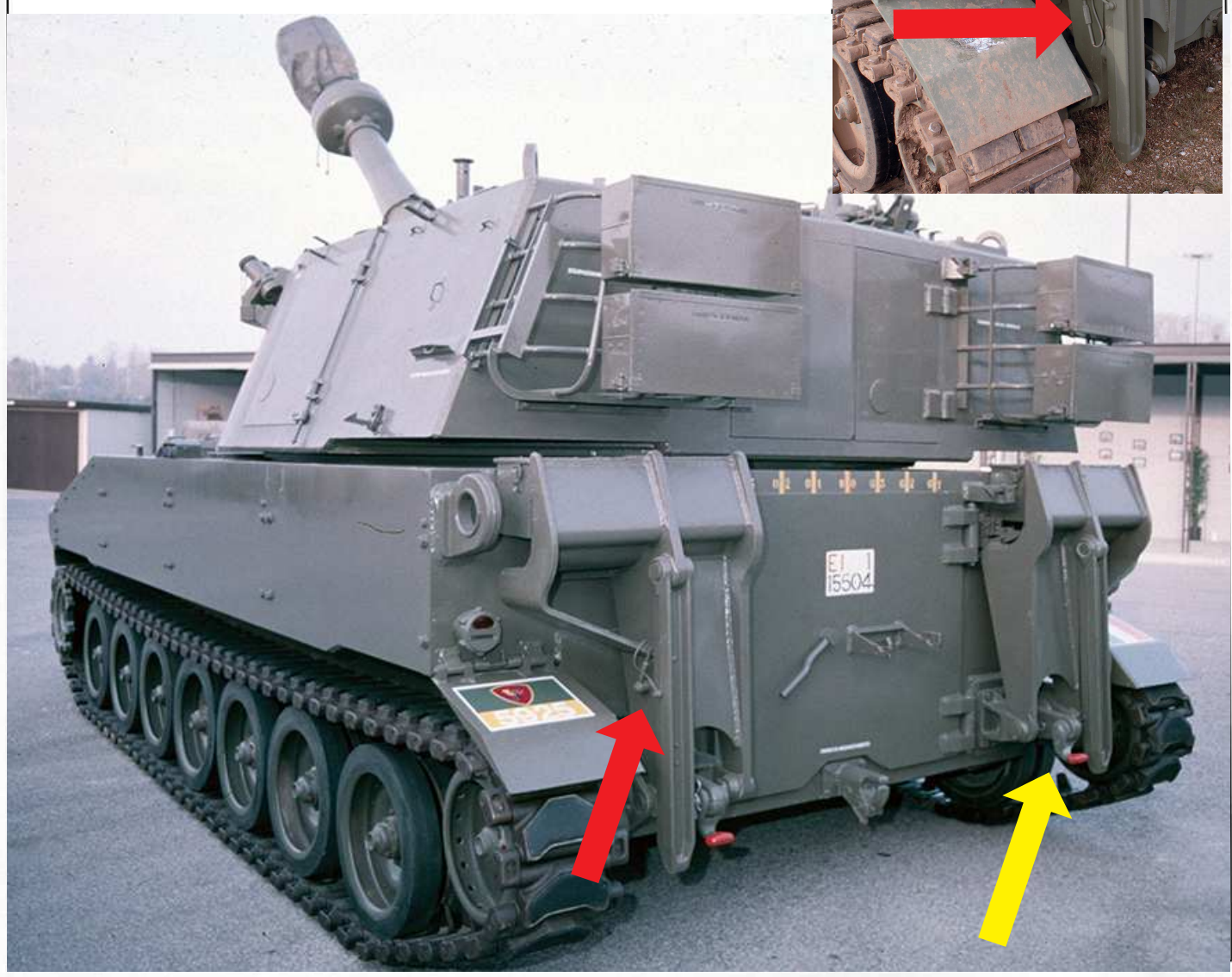

20

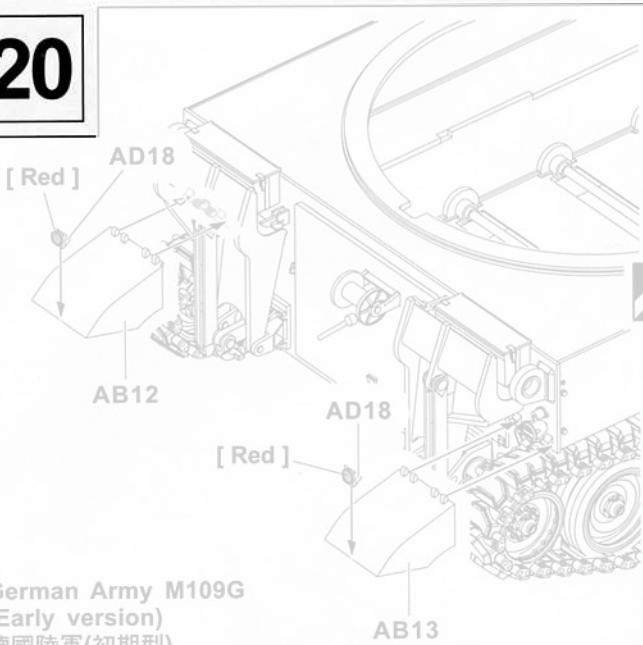

German Army M109G
(Early version)
德國陸軍(初期型)

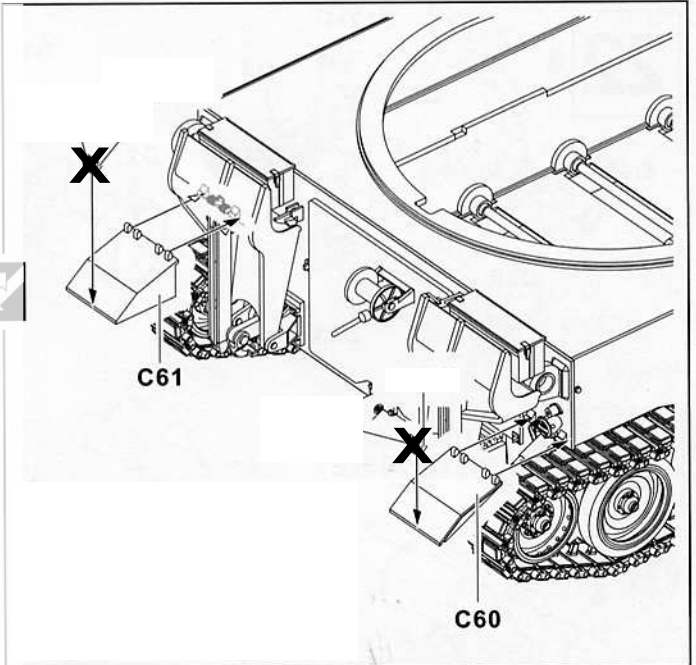

22

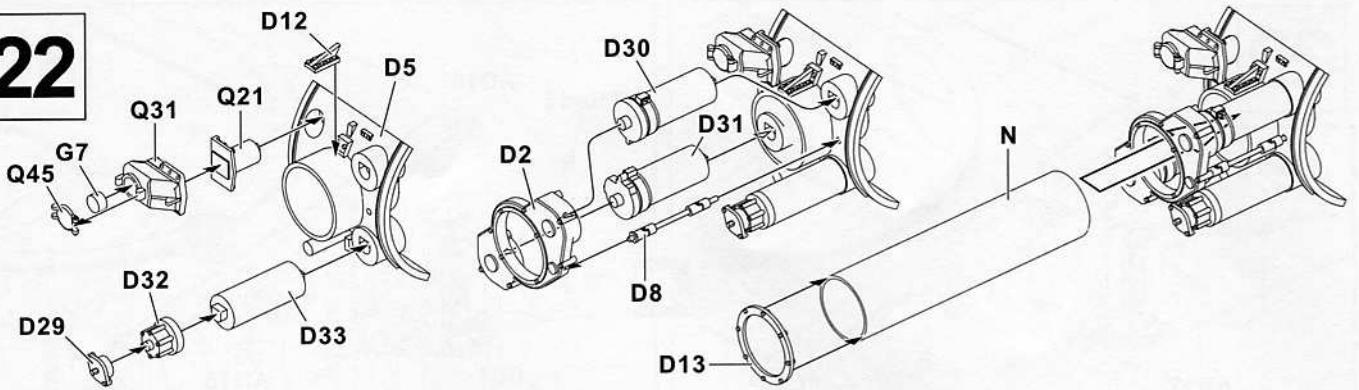

23

! **This Side Up
**注意此面朝上

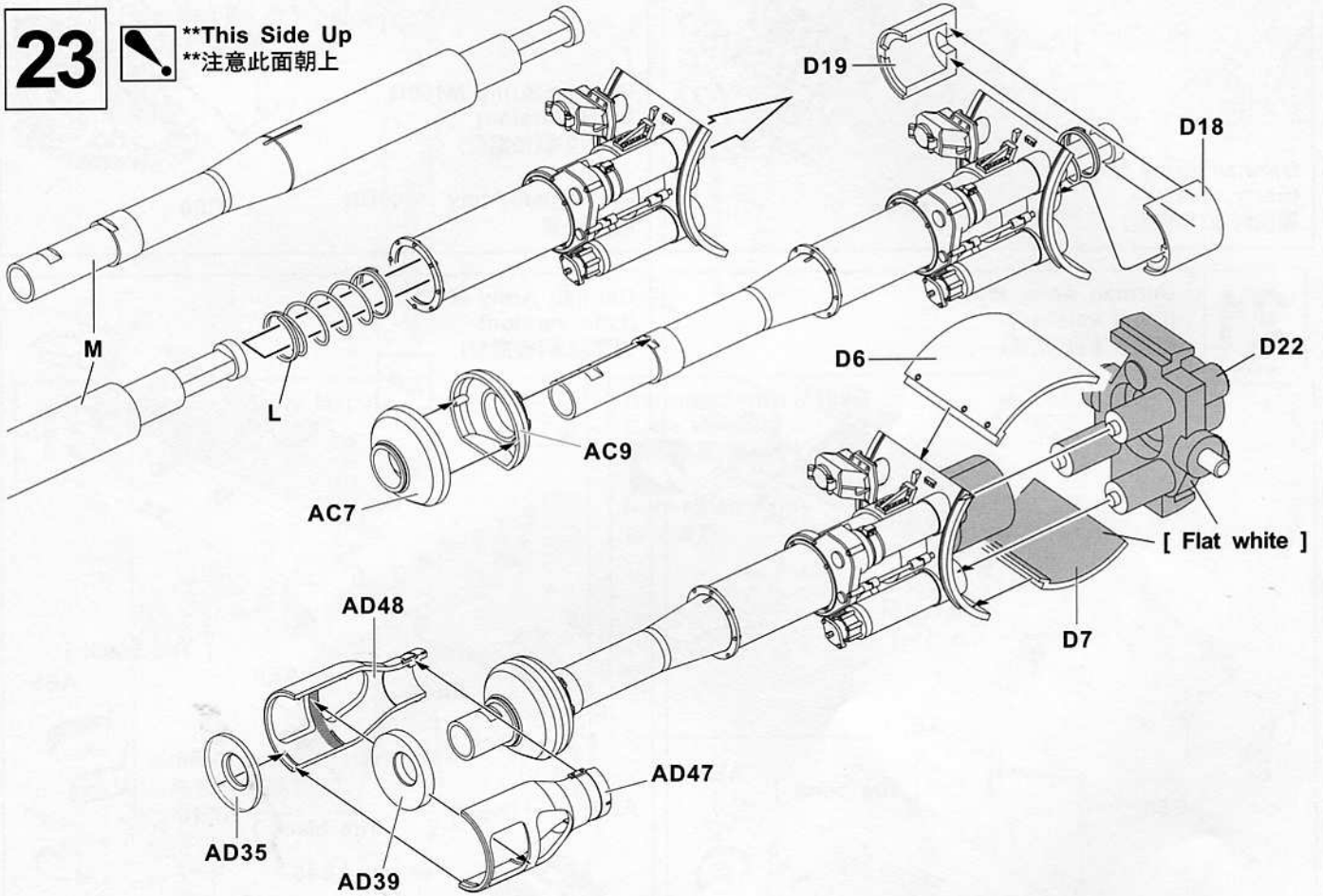

24

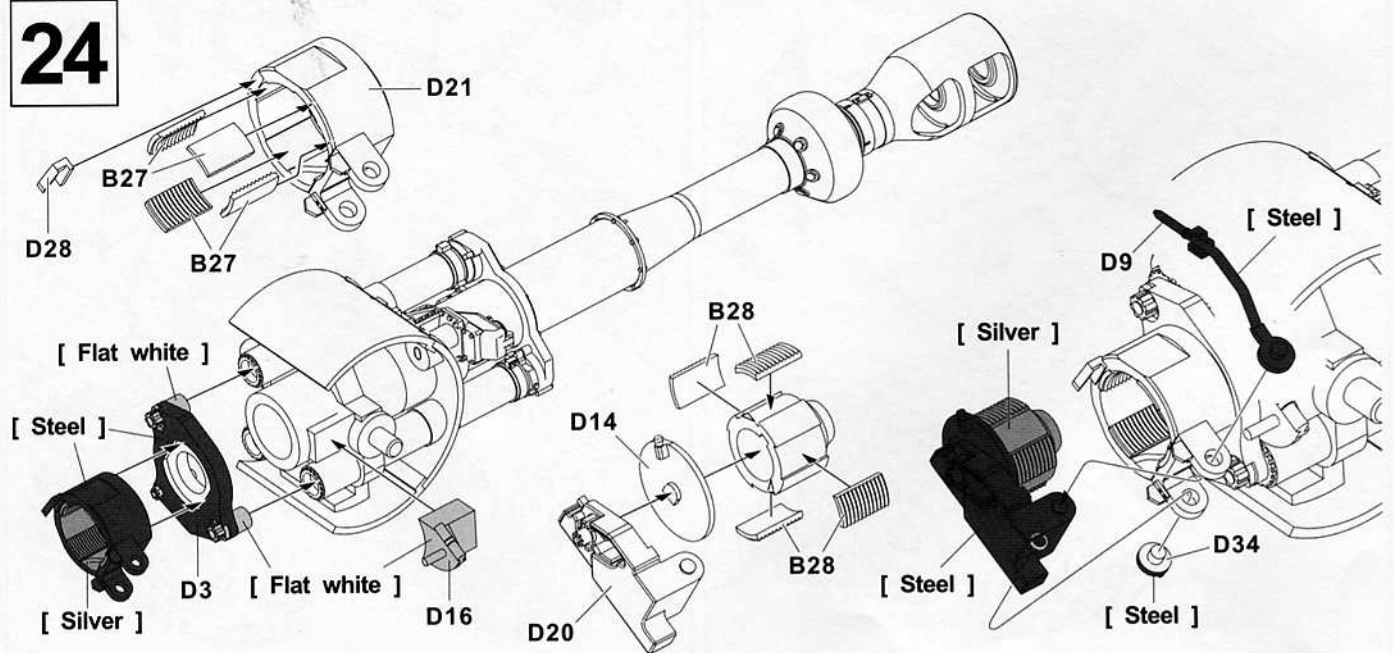

25

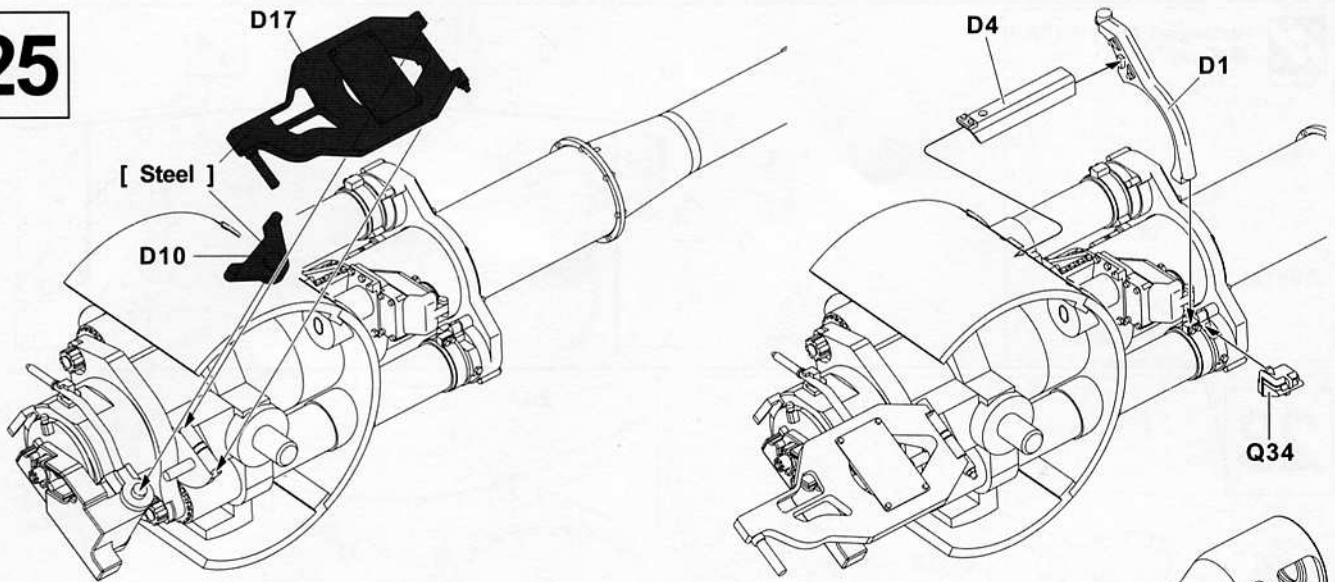

26

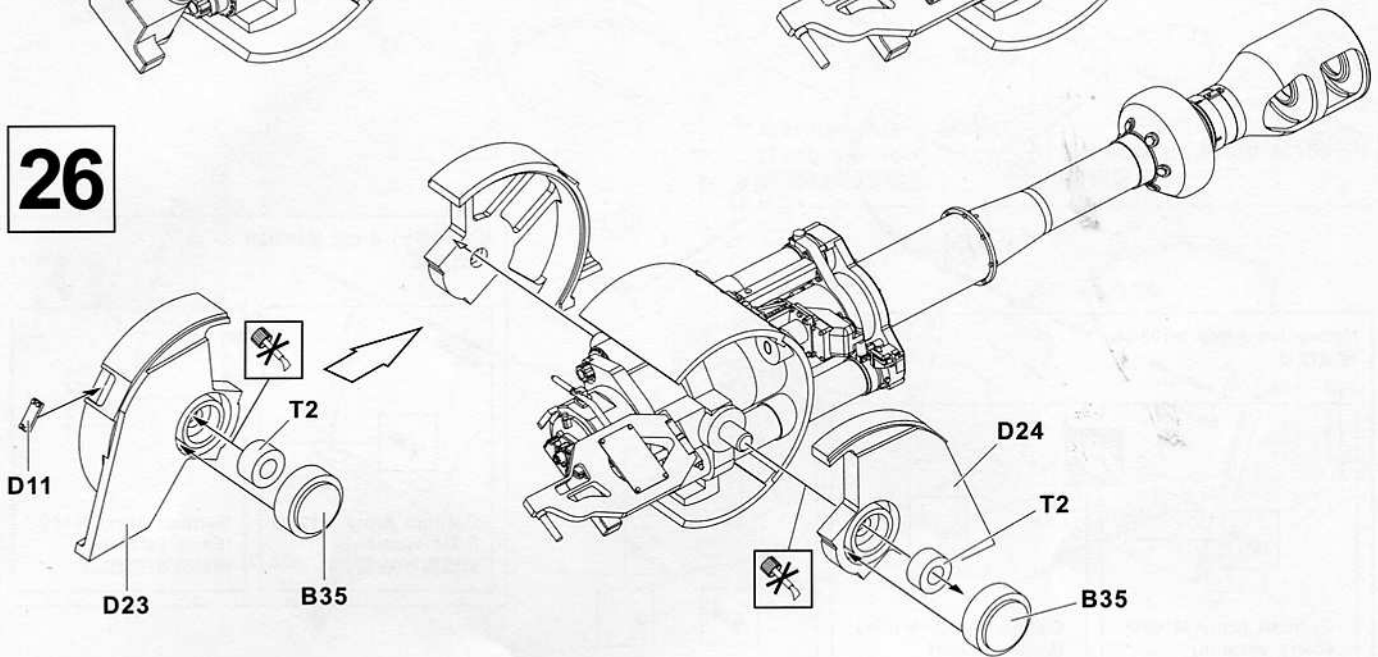

27



**FORARE SOLO I PUNTI
"A" ED "F"**

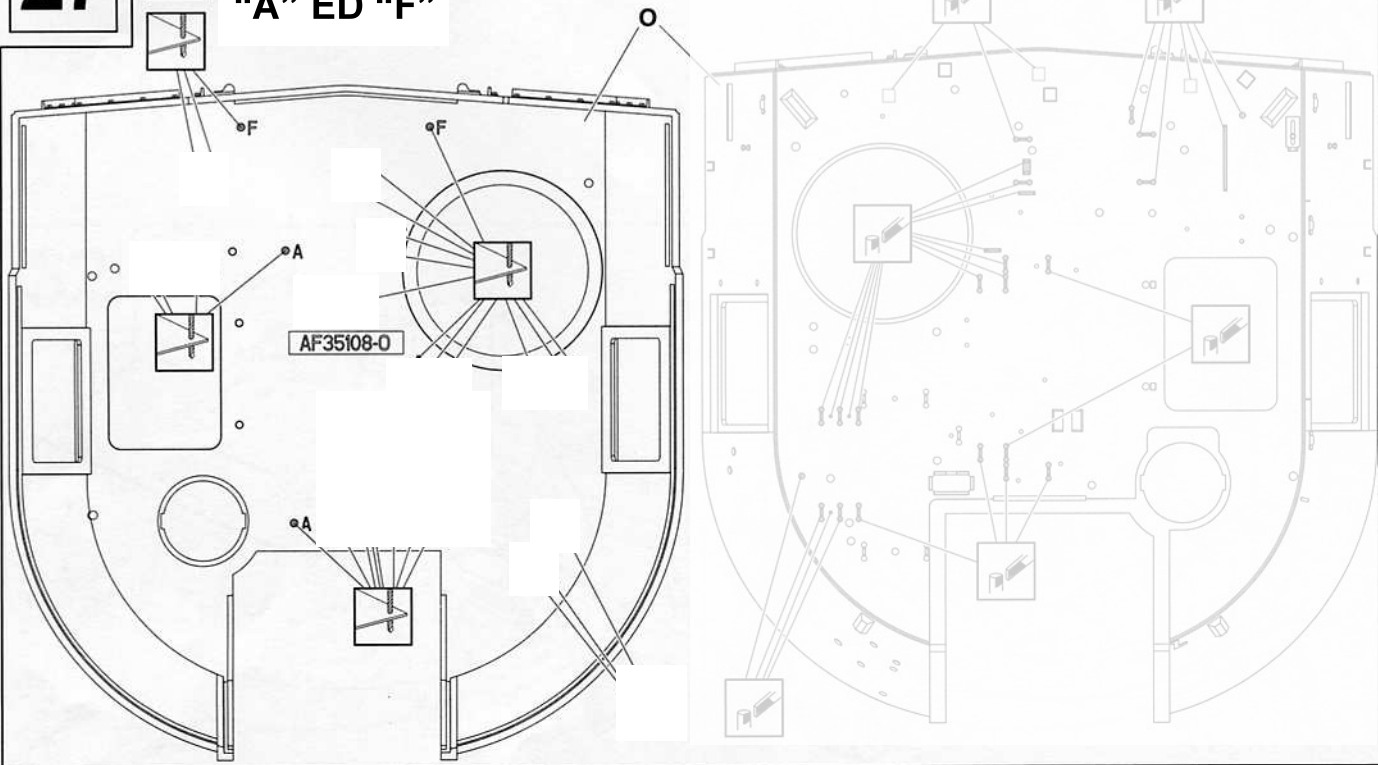

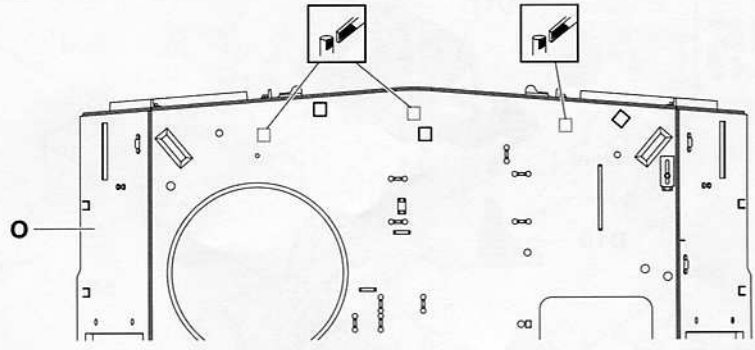

28

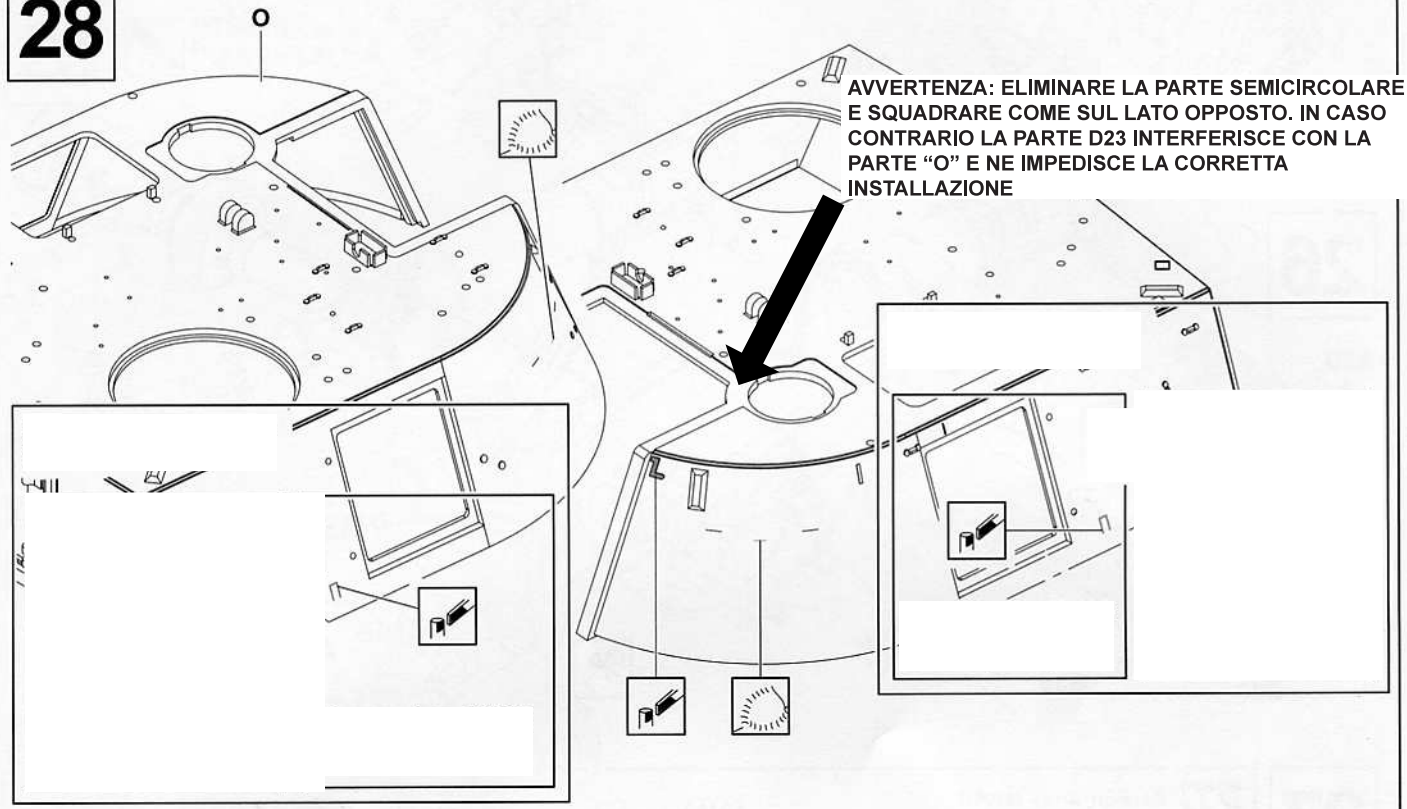

AVVERTENZA: ELIMINARE LA PARTE SEMICIRCOLARE E SQUADRARE COME SUL LATO OPPOSTO. IN CASO CONTRARIO LA PARTE D23 INTERFERISCE CON LA PARTE "O" E NE IMPEDISCE LA CORRETTA INSTALLAZIONE

29

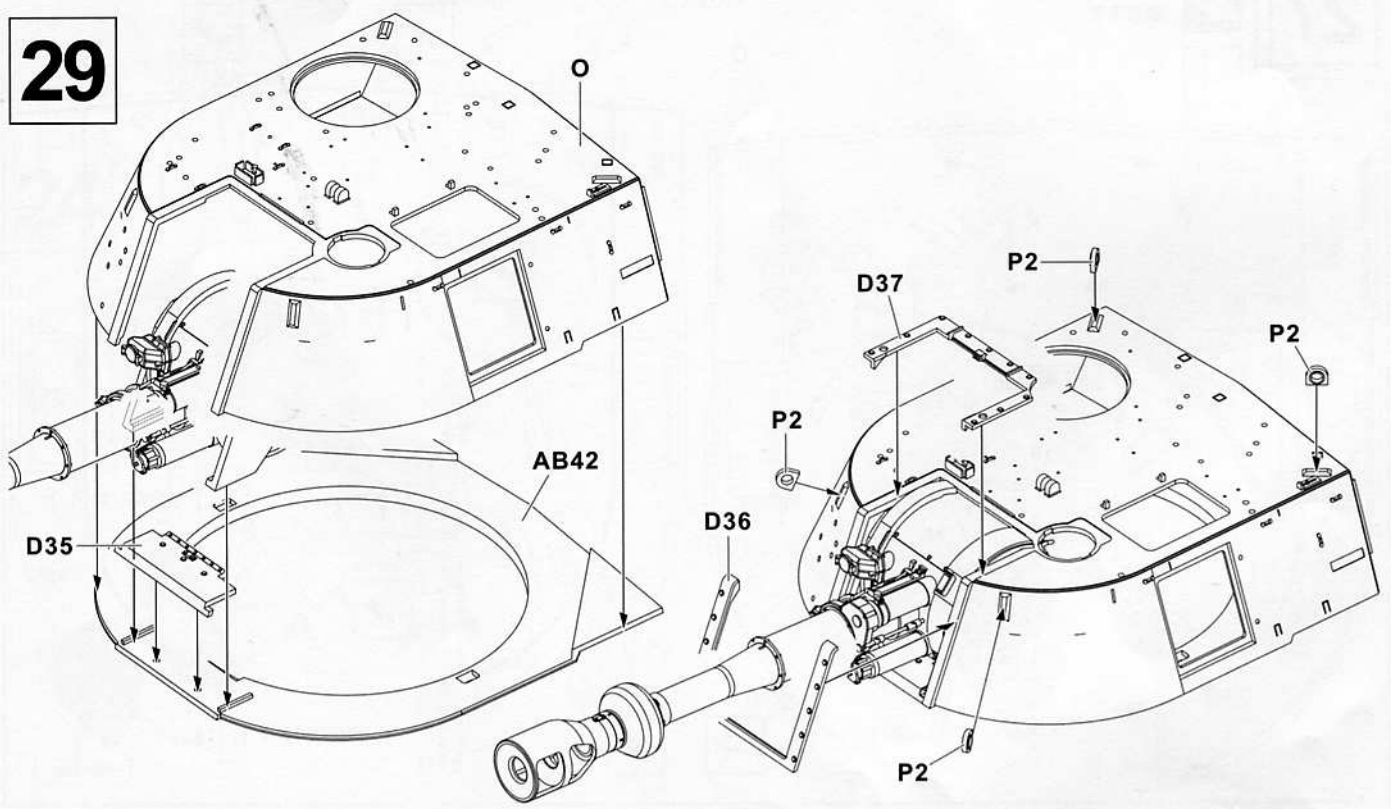

30

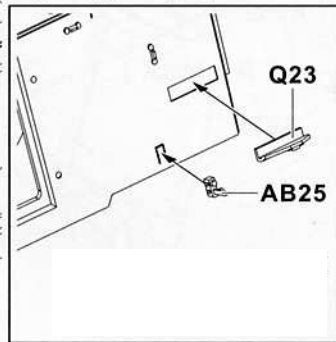
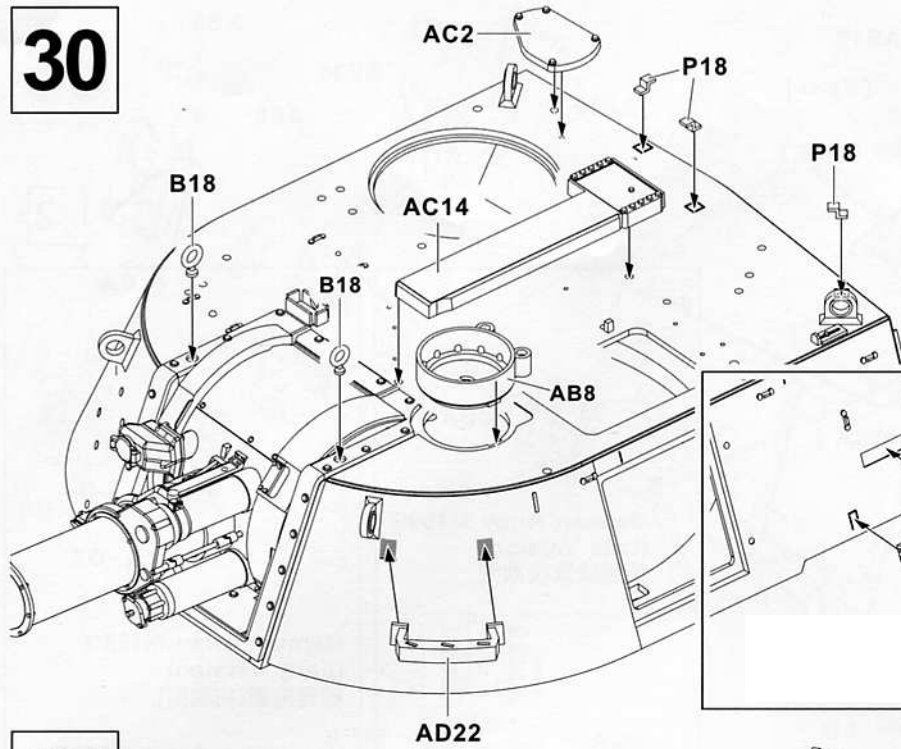

31

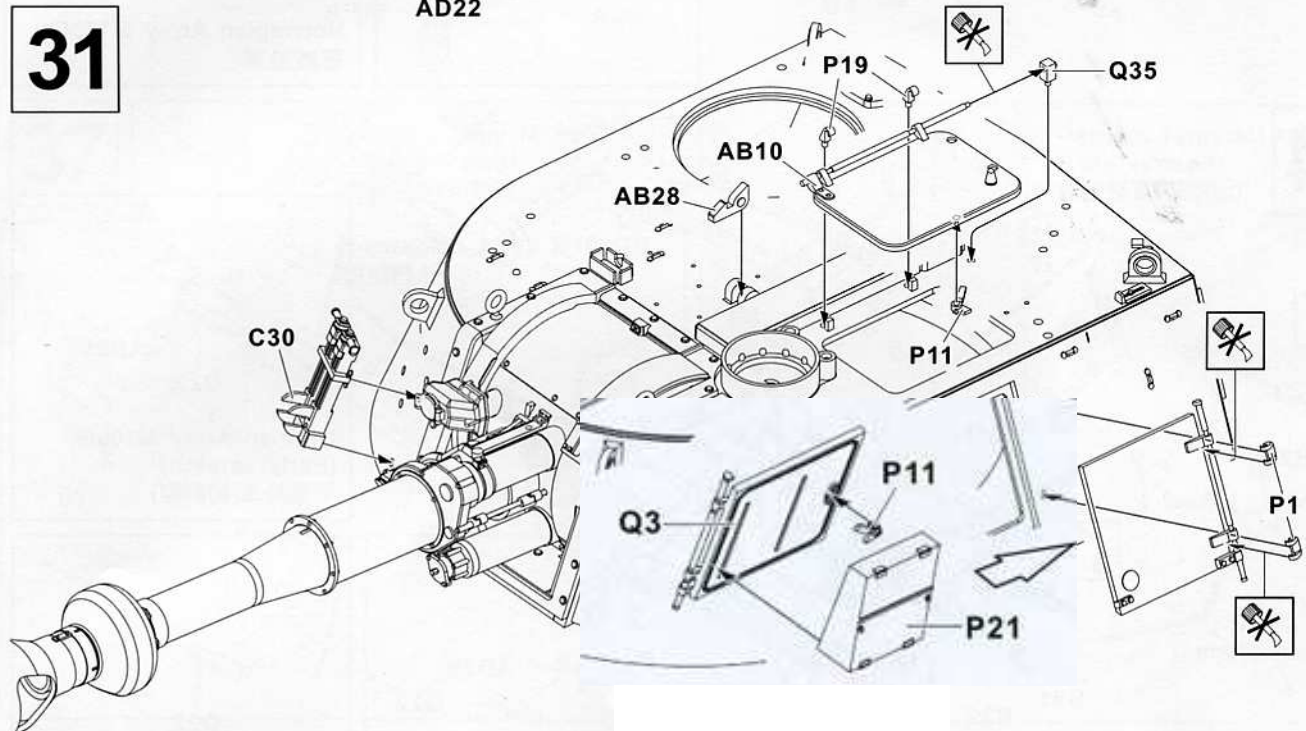

32

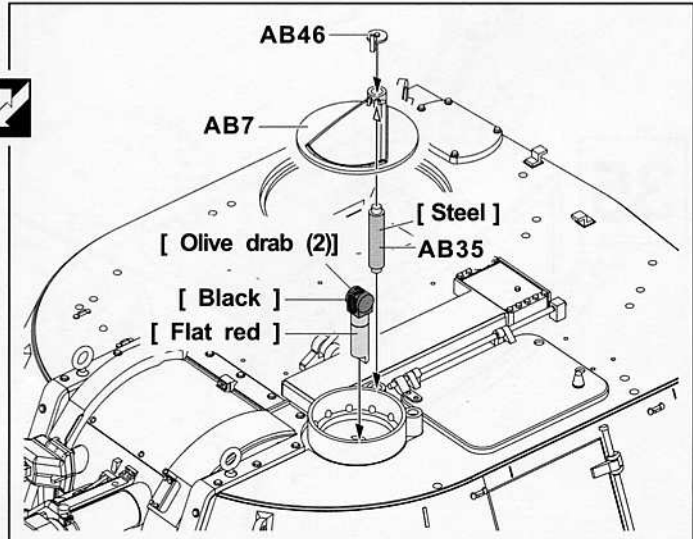
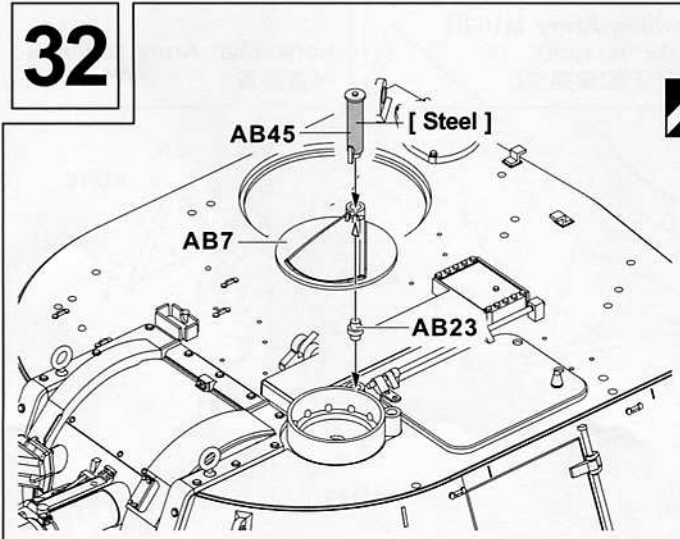

33

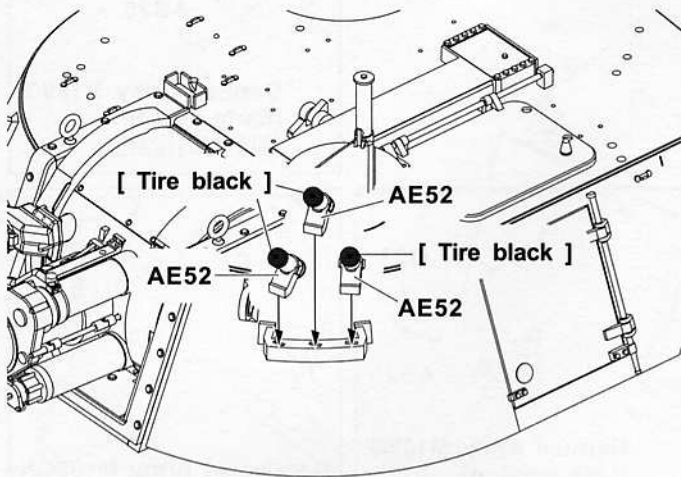
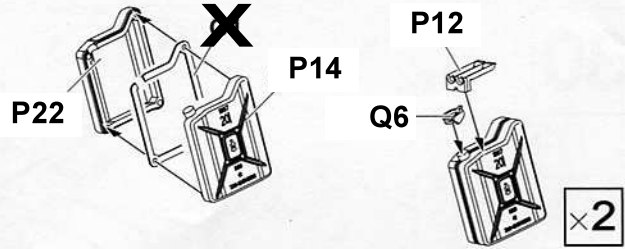
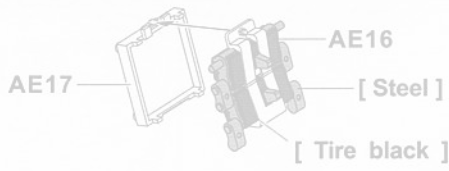

German (Late 德國陸

(Early version) 德國陸軍(初期型)

Norwegian Army M109GN 挪威陸軍

34

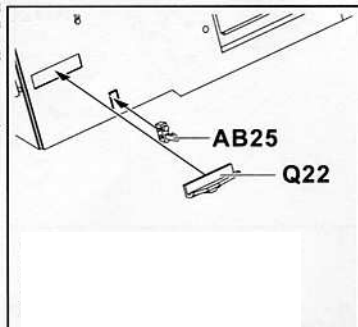
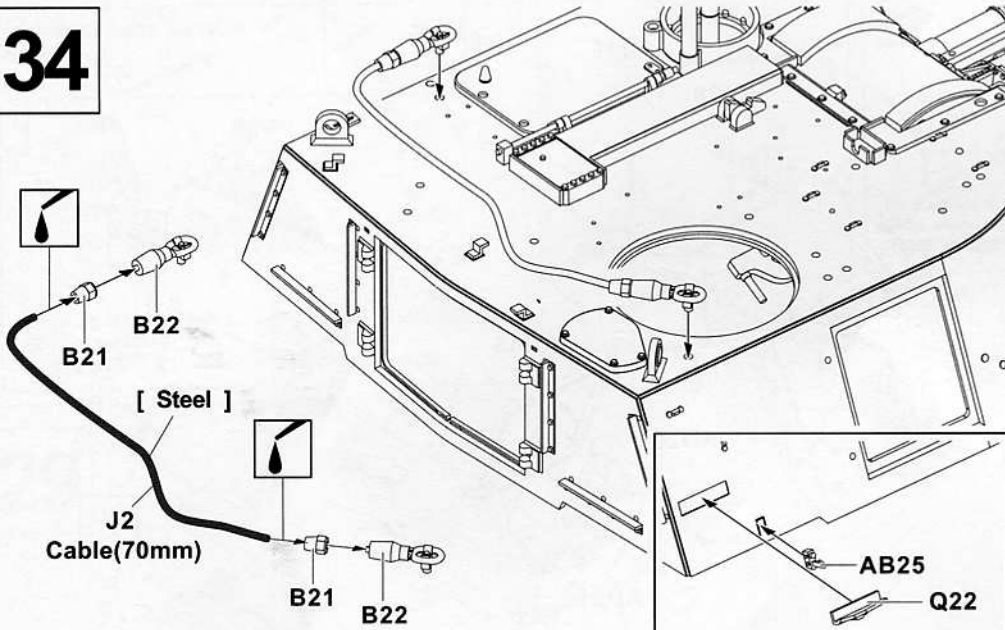

35

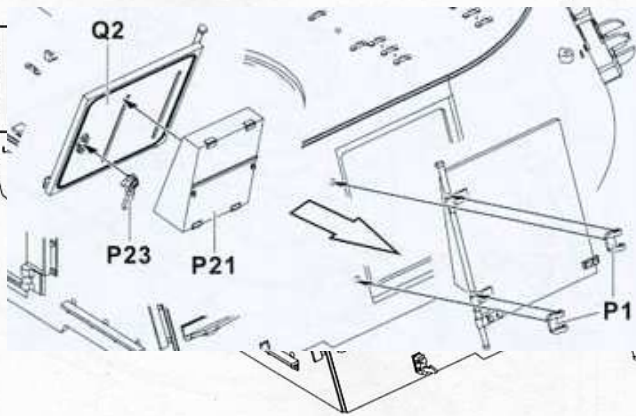

36

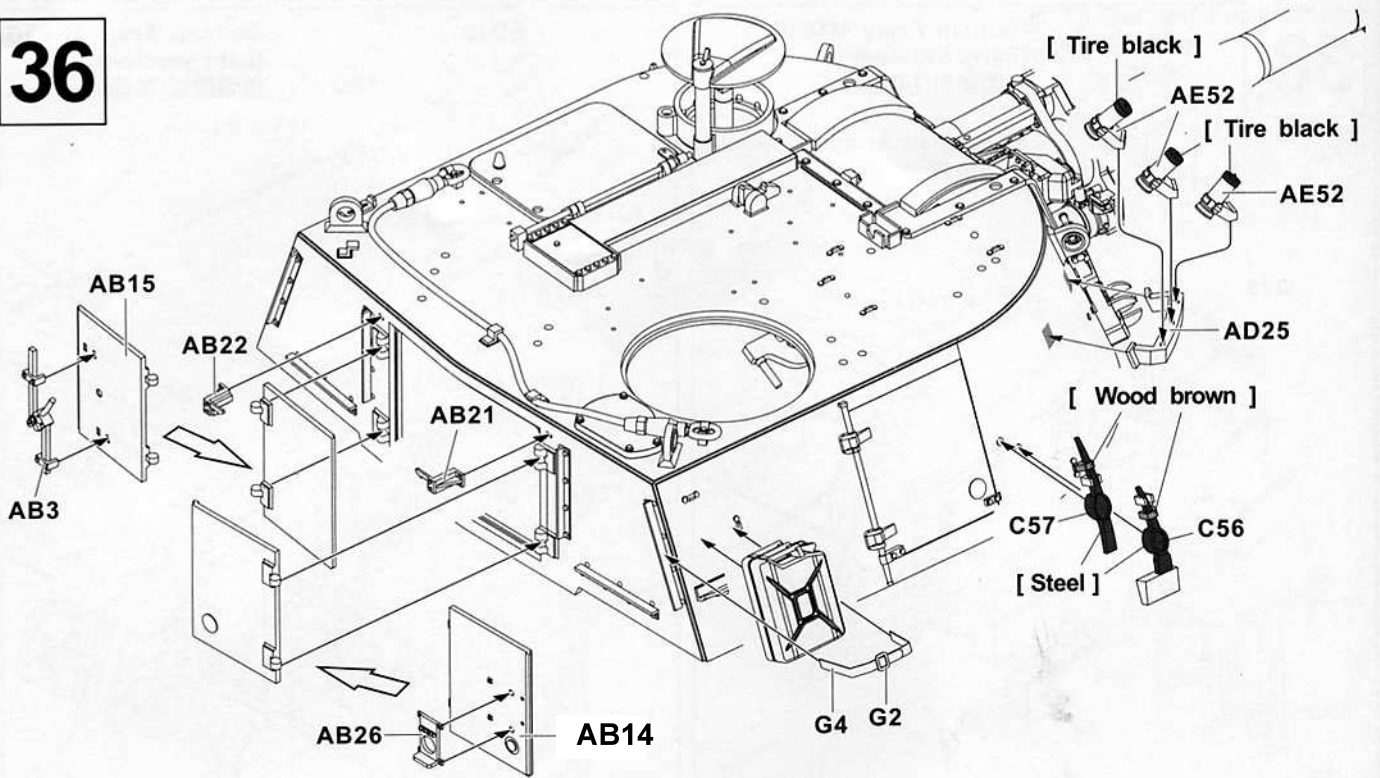

37

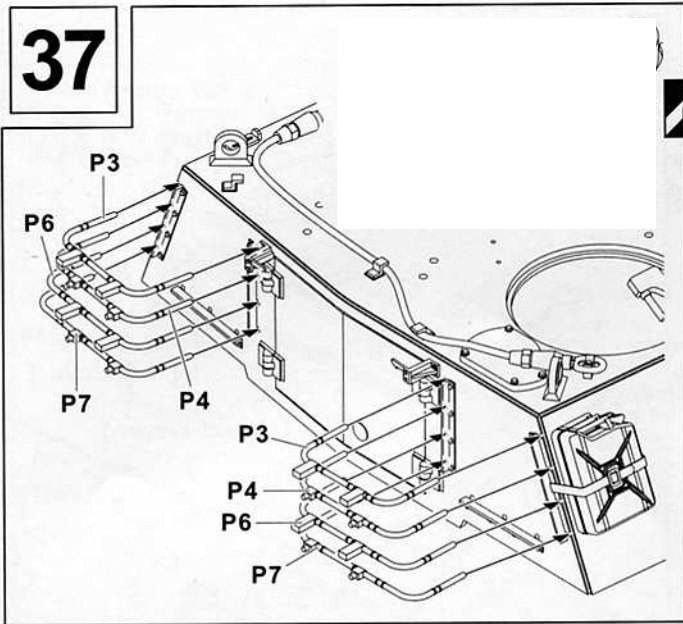

ELIMINARE SU ENTRAMBI I LATI



STUCCARE SU ENTRAMBI I LATI

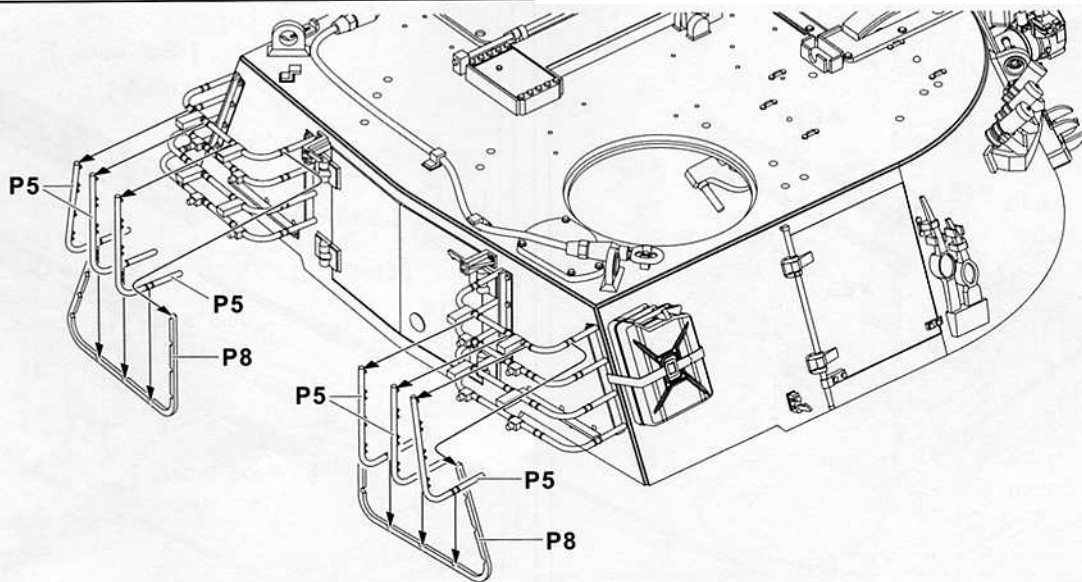

38

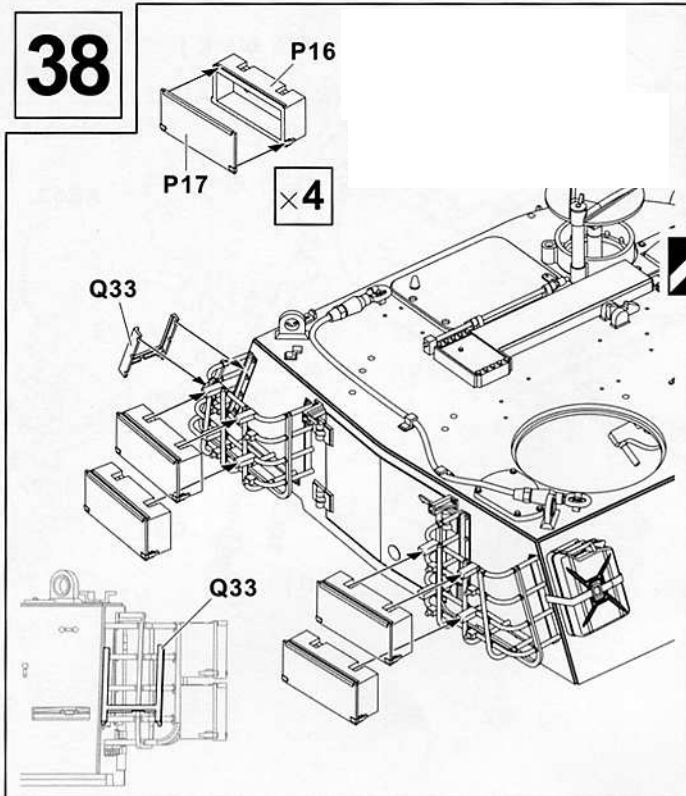

TIPO DI FERMI DEI PORTELLI PRESENTI SOLO SUGLI M109L

39

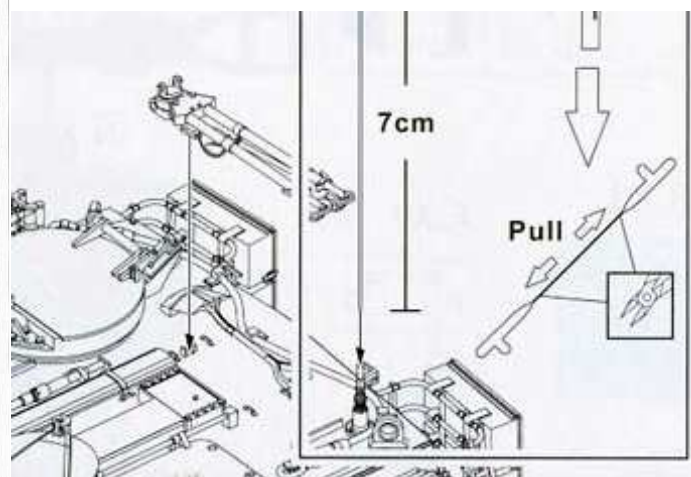
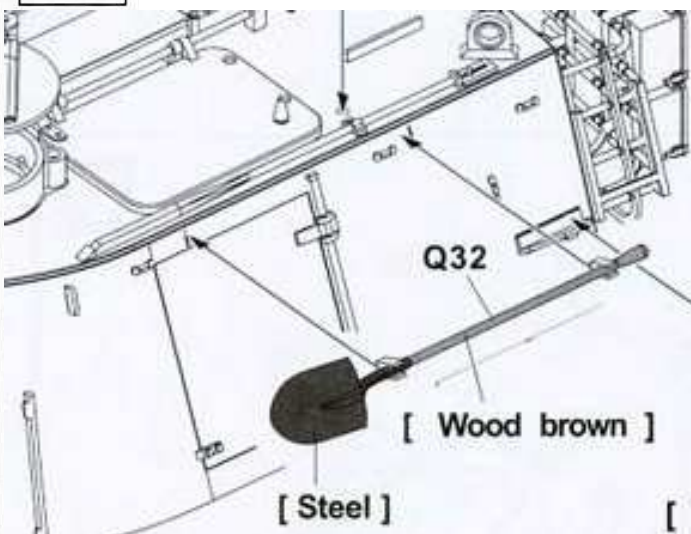

N.B. IL TREPPIEDE DELLA MITRAGLIATRICE 0.50 NON E' FORNITO CON IL KIT MA SOLITAMENTE NON ERA INSTALLATO

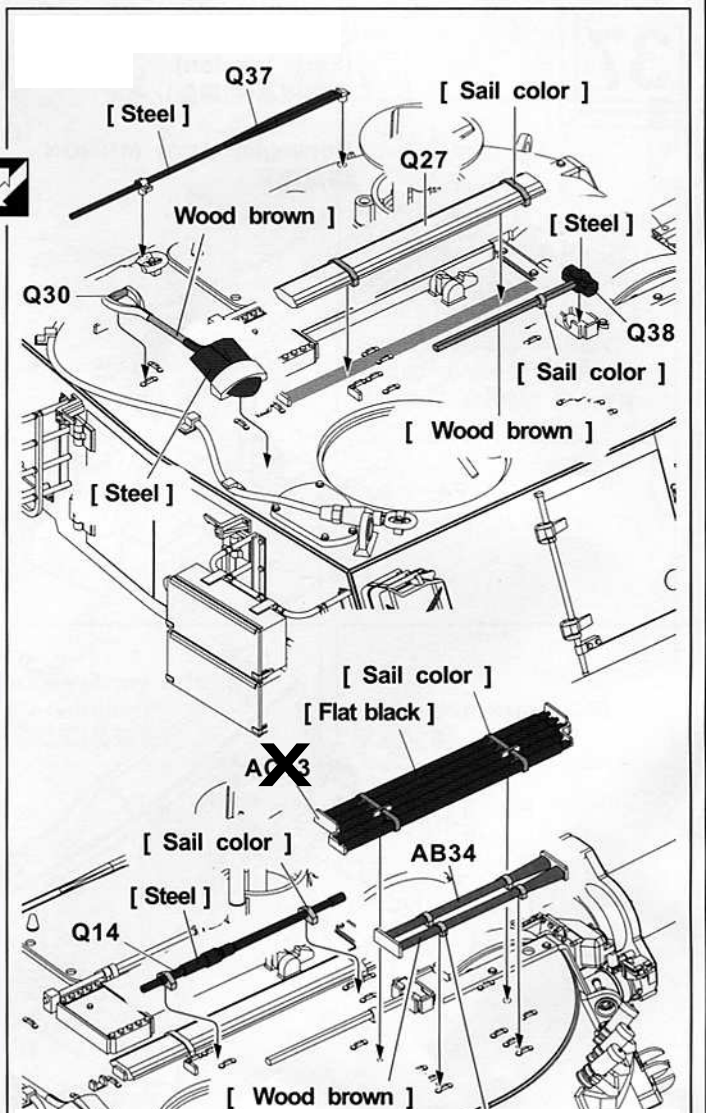

N.B. LA CANNA DI RISERVA DELLA MITRAGLIATRICE (Q14) NON VENIVA SOLITAMENTE INSTALLATA. INSTALLARE SOLO I SUPPORTI

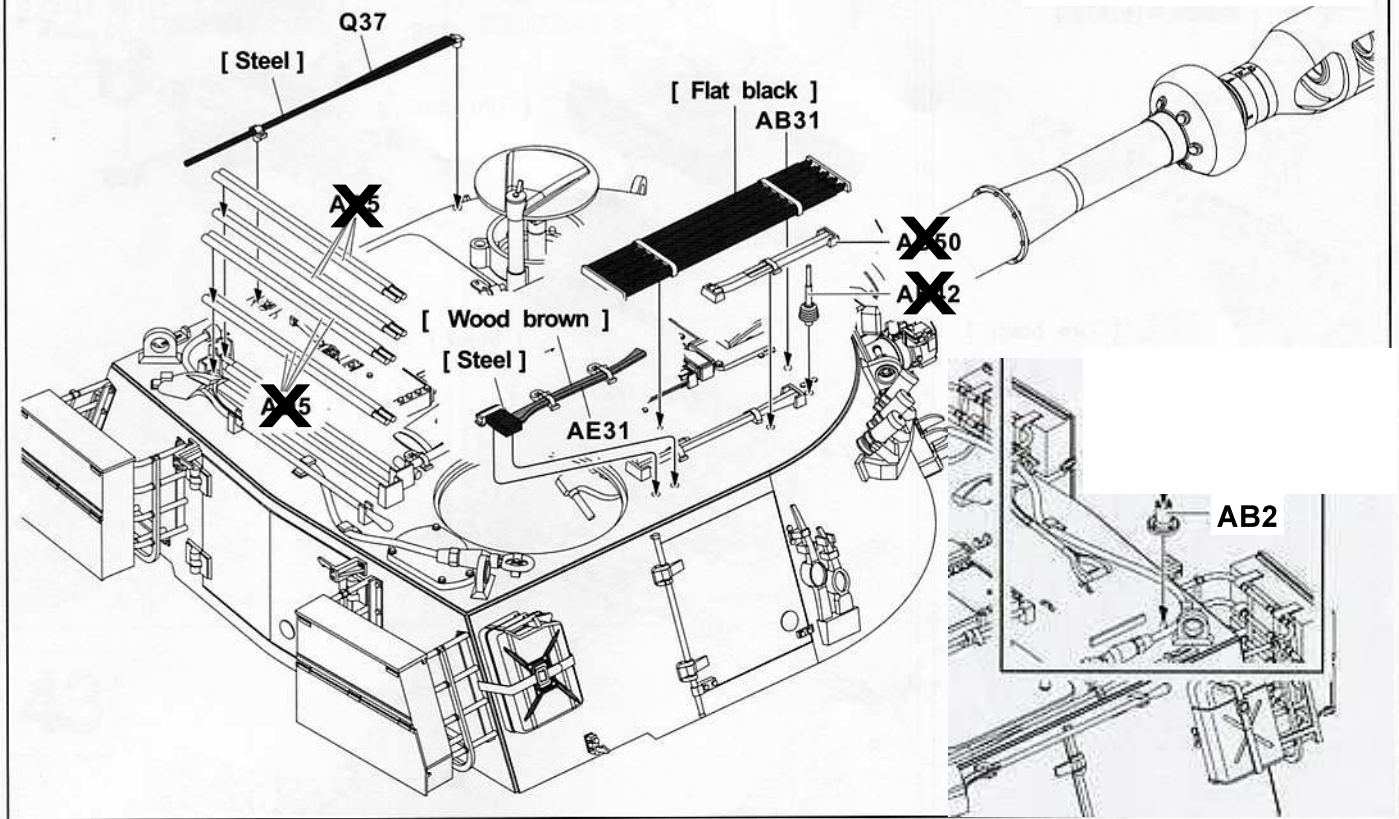

40

German Army M10
(Late version)
德國陸軍後期型

**N.B. IN ESERCITAZIONE
I SEMOVENTI NON
MONTAVANO L'ANTENNA
RADIO**

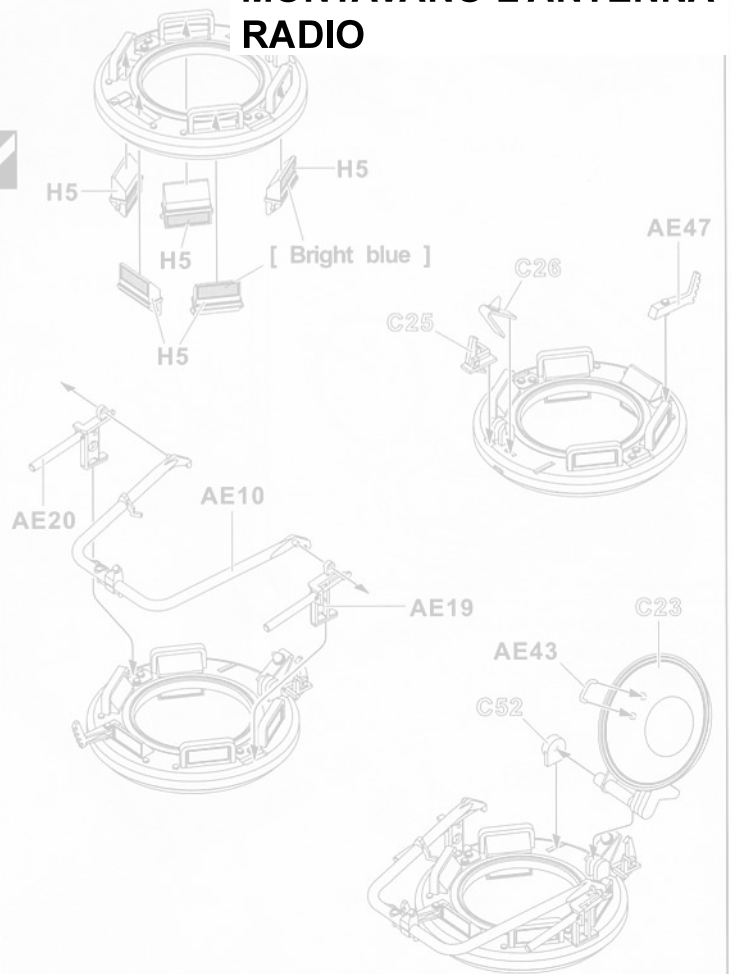
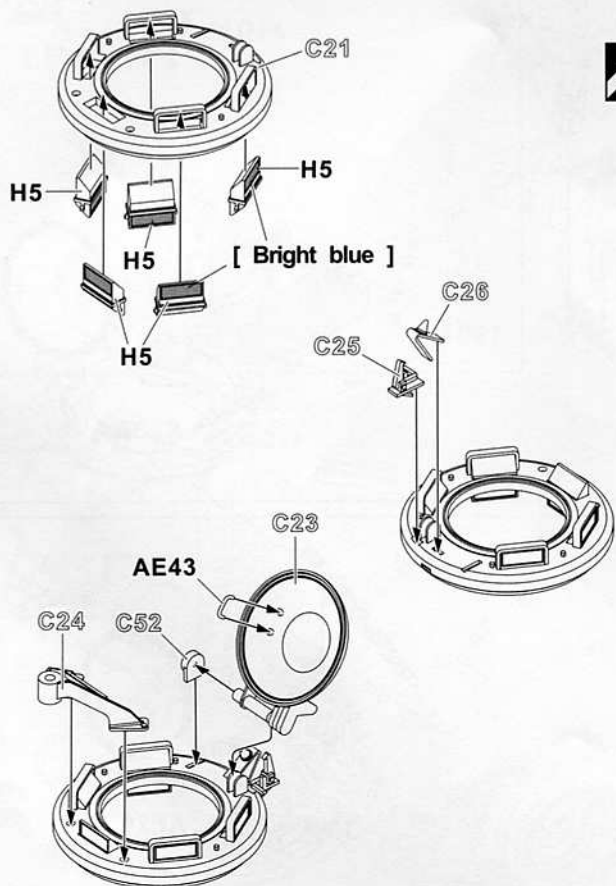

41

German Army M109G
(Early version)
德國陸軍(初期型)

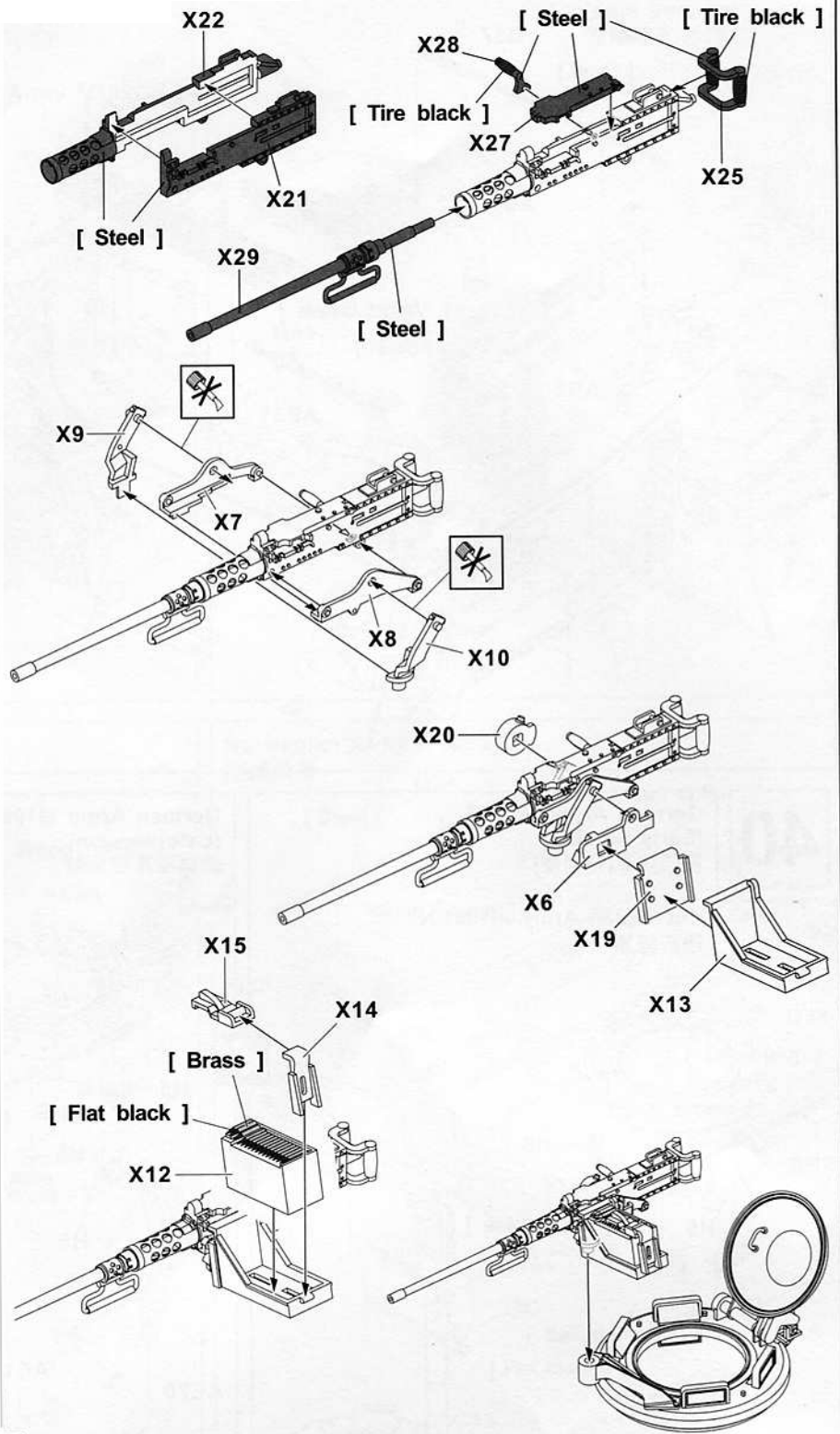
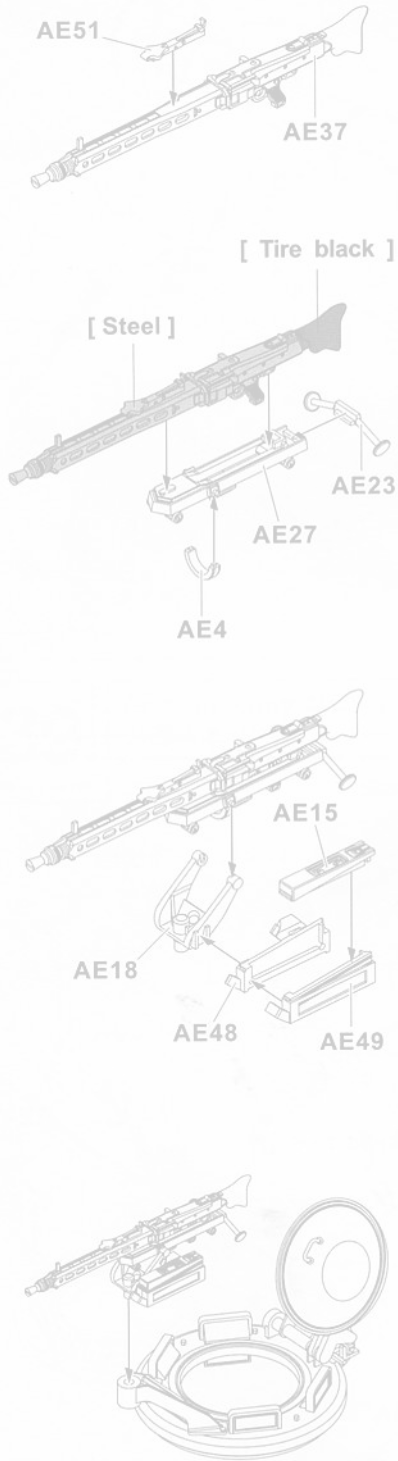

German Army M109G
(Late version)
德國陸軍後期型

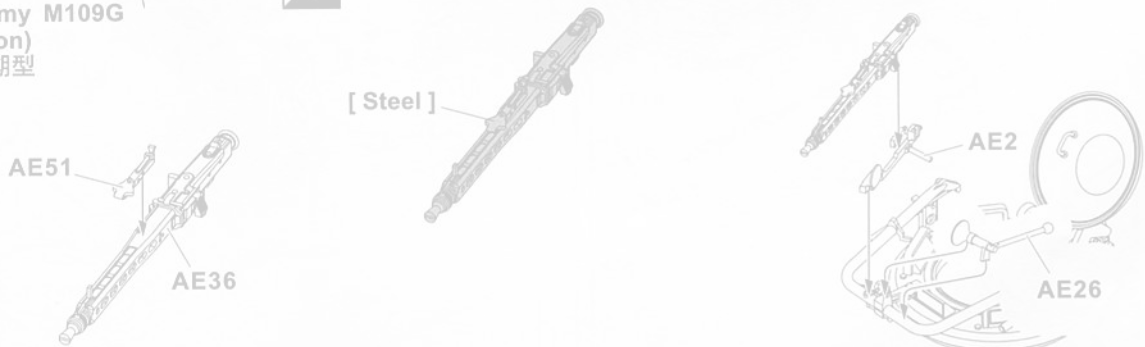

42

German Army M109G
(Early version)
德國陸軍(初期型)

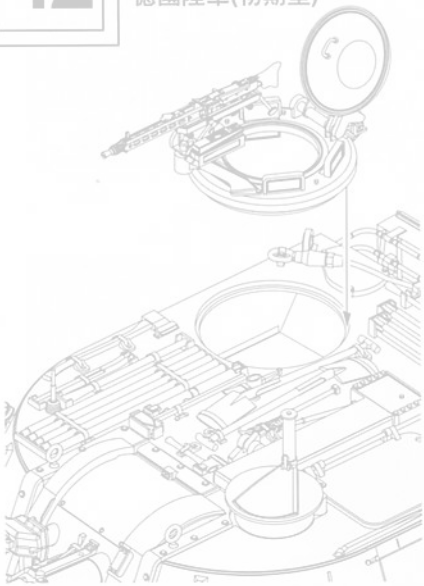

German Army M109G
(Late version)
德國陸軍(後期型)

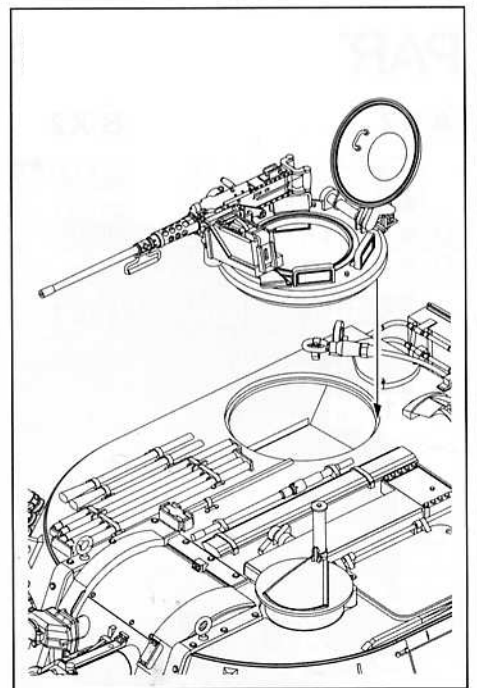
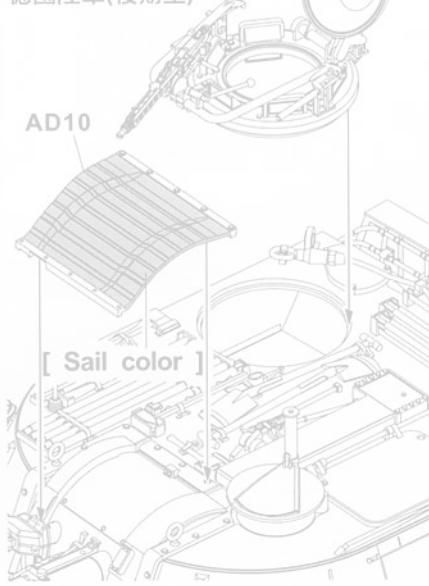

43

